

BO145L EV

BOLLARDS AND HEIGHT LIMITERS

Revision: 17 June 2024 9:22 AM
Boplan reference: BO145L0-...



PRODUCT SPECIFICATIONS

APPLICATION	
Environment	The BO145L EV helps prevent accidents, minimizes damage, and maintains safe accessibility to electric mobility. With their visibility and impact-resistant flexibility, EV-bollards are the most effective solution for the protection of charging stations against potential vehicle impacts.
Impact performance	2000 Joule (Eq. to 2 ton - 3.1 mph)
OPTIONAL	
Stripes	Colored reflective stripes providing a high level of visibility.
MATERIAL	
Tube	Extrilene® - UV resistant - Fire class E ⁺ - Non conductive - Impervious to most chemicals ^{***}
Cap	Sustainable elastomer
Socket	Sustainable elastomer
STANDARD COLORS	
Bollard	Standard: Black RAL 9005 Also available in Yellow RAL 1003 and White RAL 9003 (Multicolor)

⁺Classification according to EN 13501-1:2007 +A1:2009 - Fire classification of construction products and building elements.

^{**}Ask your local sales office for resistance to specific chemicals.

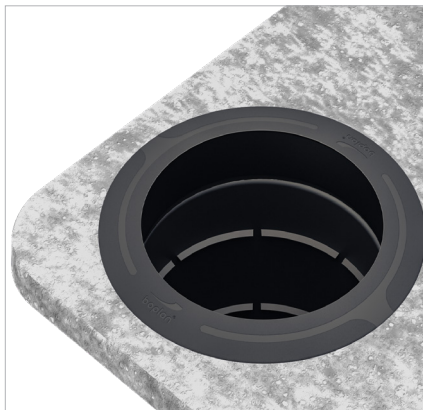

FEATURES AND FUNCTIONALITY - B0145L EV

SIZE	
Height	40 in 30 in
Profile section post	Tube: Ø5.7 in (0.3 in thick)
Seal	ID: Ø5.7 in OD: Ø7.7 in
Socket	Diameter: Ø6.5 in Height: 10.2 in

REQUIREMENTS	
Concrete quality	minimum C25/30
Concrete floor plate thickness (in)	minimum 6 in
Concrete slab dimension around posts (in)	15.7 (h) x 15.7 (w) x 11.8 (d)
Operational temperature	14 °F up to 104 °F
Water and humidity	Drainage hole in socket



IMPACT LABEL FOR SAFETY BARRIERS

BOPLAN B0145L EV

IMPACT RATING

E50	< 50 kJ
E40	< 40 kJ
E30	< 30 kJ
E25	< 25 kJ
E20	< 20 kJ
E15	< 15 kJ
E12	< 12 kJ
E10	< 10 kJ
E7	< 7.5 kJ
E5	< 5.0 kJ
E2	< 2.5 kJ
E1	< 1.0 kJ

2 kJ



IMPACT RESULTS

Deflection:
At maximum impact energy

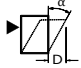

$\alpha = 20.8^\circ$
 $D_1 = 262 \text{ mm} / 10 \frac{1}{4} \text{ inch}$

SUCCESS CRITERIA

VEHICLE STOPPED
ASI (ACCELERATION SEVERITY INDEX) <0.5

TEST CONDITIONS

TEMPERATURE: 22°C / 41°F
IMPACT HEIGHT: 450 mm / 17 3/4 Inch → $D_1 = 262 \text{ mm} / 10 \frac{1}{4} \text{ Inch} \rightarrow \alpha_1 = 20.8^\circ$
TEST FLOOR: CONCRETE SLAB C25/30 - 190 mm / 7 1/2 Inch

BOPLAN TEST LAB

Muizelstraat 12
8560 Moorsele
Belgium



TEST VEHICLE:

TYPE: BOPLAN IMPACT TEST VEHICLE
WEIGHT: 3775 Kg / 8322.45 lbs
SIZE (L x W x h): 3100 x 1100 x 1150 mm / 122 x 43 1/4 x 45 1/4 Inch
CONTACT AREA, STEEL BUMPER WIDTH: 1000 mm / 39 1/4 Inch

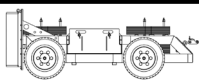

PRODUCT TESTED

Boplan Test Lab

IL-B0145LEV-20230927

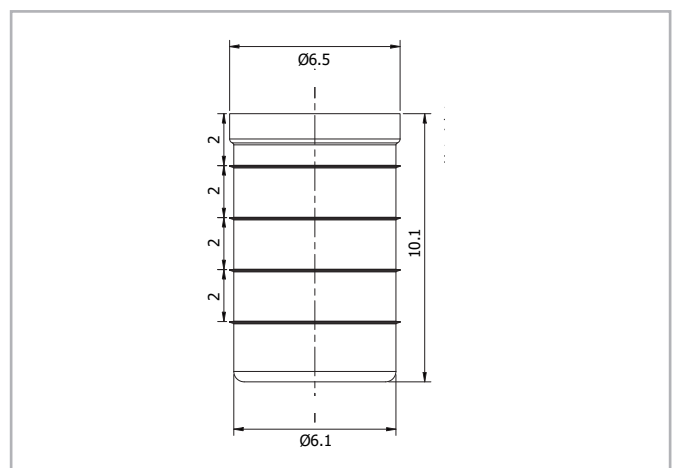
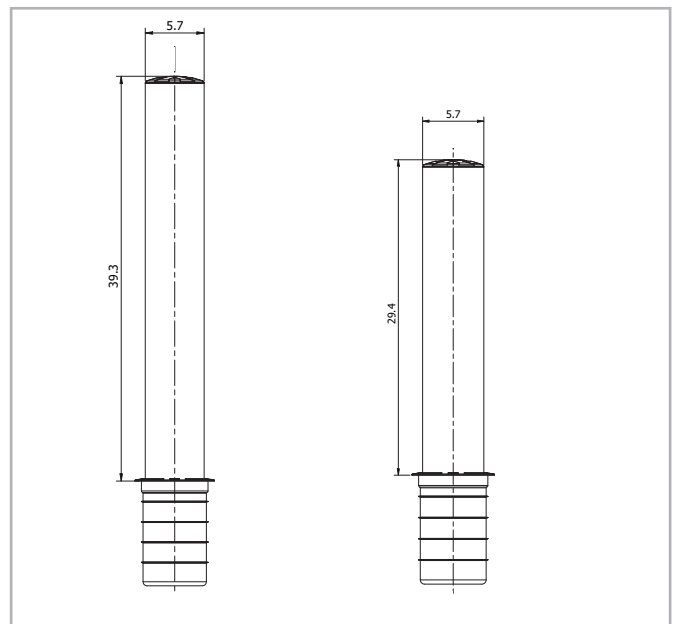

REFERENCE LIST - B0145L EV

	BLACK	MULTICOLOR <input type="checkbox"/> <input type="checkbox"/>
40 in	B0145L0-1000-01EVBL	B0145L0-1000-01EVMC
30 in	B0145L0-0750-01EVBL	B0145L0-0750-01EVMC

STRIPES			
	White	Black	Yellow
1 STRIPE	PA0301-0125-0001WH	PA0301-0125-0001BL	PA0301-0125-0001YE
	