

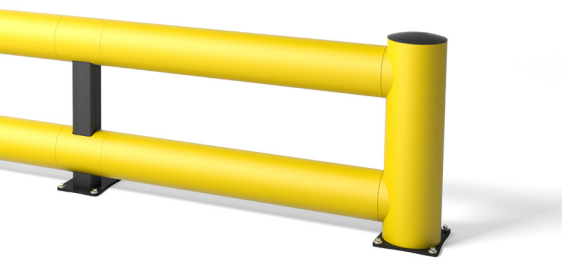

TB 260 DOUBLE BOPLAN SAFETY BARRIER SPECIFICATION SHEET

Revision: 10 July 2023 11:44 AM
Boplan reference: DT260 ...



PRODUCT SPECIFICATIONS

APPLICATION			
Environment	A double traffic barrier that closely resembles a guardrail which goes the extra mile in shielding pedestrians from vehicle collisions. The lower centre of gravity provides extra strength.		
Impact performance at 90°	POST:	39800 Joule (Eq. to 10 ton - 6.3 mph)	
	RAIL:	46500 Joule (Eq. to 10 ton - 6.8 mph)	
MATERIAL			
Posts and rails	Novilene® - UV resistant - Fire class E° - Non conductive - Impervious to most chemicals**		
STANDARD COLORS			
End post	Yellow		
Mid post	Yellow		
Tubes (rails)	Yellow		
BASEPLATES			
	Steel	Zinc Coated Steel	Stainless steel
Material	Steel 37	Steel 37	Stainless steel 304
Coating	Lacquered	Lacquered + electro plating	No Itacquer / No coating
Color	High gloss black	Matt black	Natural color

*Classification according to EN 13501-1:2007 +A1:2009 - Fire classification of construction products and building elements.
**Ask your local sales office for resistance to specific chemicals.

FIXATIONS			
		ZC (Zinc coated)	SS (Stainless steel)
STANDARD	Expansion anchor		

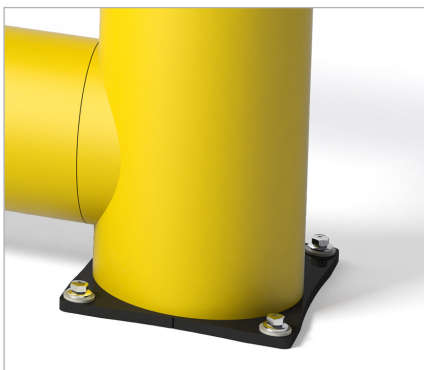

FEATURES AND FUNCTIONALITY - TB 260 DOUBLE

SIZE	
Height end posts	31 in
Height mid post	29 1/2 in
Profile section tubes	Ø8 in (2/5 in thick)
Profile section end posts	Outer tube: Ø10 mm (2/5 in thick) Inner profile: 4 2/5 x 4 2/5 in (1/3 in thick)
Profile section mid posts	Profile: 4 2/5 x 4 2/5 in (1/3 in thick)
Standard rail length	CC60 in (Tube length: 50 in)
Baseplate	End Post: 12 2/3 x 10 4/5 in (1/2 in thick) Mid Post: 12 2/3 x 10 4/5 in (1/2 in thick)

REQUIREMENTS	
Concrete quality	minimum 400 PSI (C25/30)
Concrete floor plate thickness	minimum 6 in
Concrete slab dimension around posts (in)	31 1/2 (H) x 31 1/2 (W) x 23 2/3 (D)
Operational temperature	14 °F up to 104°F
Water and humidity	Steel (standard): dry indoor use only. Zinc coated: outdoor use in most environments. Stainless Steel: outdoor use or frequent exposure to water and humidity.

IMPACT LABEL FOR SAFETY BARRIERS

BOPLAN TB260 Double		
IMPACT RATING	45°	90° <small>PAS 13:2017 compliant</small>
E80 < 80 kJ	65,7 kJ	
E60 < 60 kJ		
E50 < 50 kJ		46,5 kJ
E40 < 40 kJ		
E35 < 35 kJ		
E30 < 30 kJ		
E25 < 25 kJ		
E20 < 20 kJ		
E15 < 15 kJ		
E10 < 10 kJ		
E5 < 5,0 kJ		
E2 < 2,5 kJ		

TEST CONDITIONS

TEMPERATURE: 20°C / 68°F

IMPACT HEIGHT: 650 mm / 25 2/3 Inch

IMPACT ANGLE: 90°

TEST FLOOR: CONCRETE SLAB C25/30 - 160 mm / 6 inch

MANUFACTURER ANCHOR PULL OUT: 17kN

TEST VEHICLE

WEIGHT: 2300 KG / 5070.63 lbs

TYPE: COMMERCIAL FORK LIFT

SIZE (L x W x h): 1890x1020x1970 mm / 74x40x78 Inch

CONTACT AREA: STEEL BUMPER WIDTH: 600 mm / 24 Inch

ACCREDITED TEST LABORATORY

620 Route des Fromentaux
01500 Saint-Maurice-de-Rémens
01360 Bèlignieux
France

TRANSPOLITE

SUCCESS CRITERIA VEHICLE STOPPED - ASI (ACCELERATION SEVERITY INDEX) < 0.5

IL-DT2600-20230710

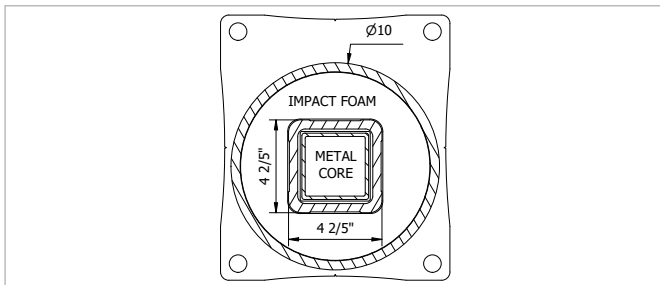
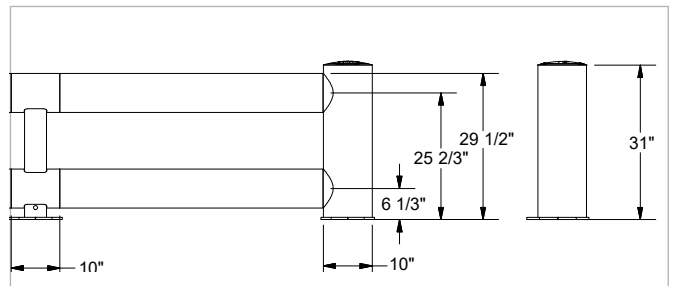
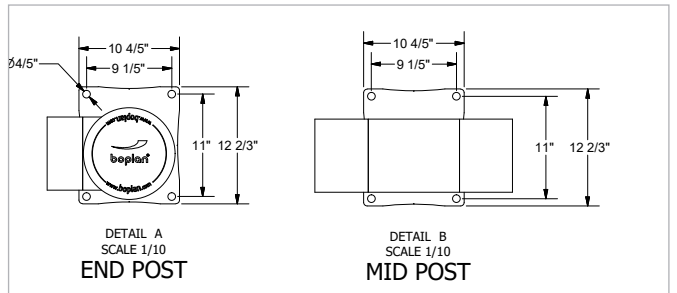

SPECSHEET

BOPLAN USA INC | Atlanta, GA | +1 678 890 5906 | sales@boplan.com | www.boplan.com

DISCLAIMER: ALL PRODUCT SPECIFICATIONS AND DATA ARE SUBJECT TO CHANGE WITHOUT NOTICE TO IMPROVE RELIABILITY, FUNCTION OR DESIGN OR OTHERWISE.
© Boplan, the Boplan logo, Flex Impact and RackBull are trademarks of Boplan bv. All other trademarks are property of their respective owners.

REFERENCE LIST - TB 260 DOUBLE

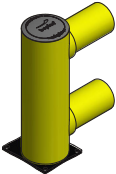
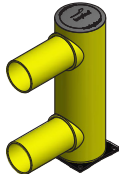
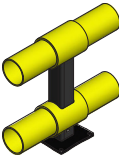
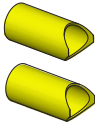
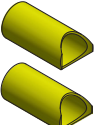
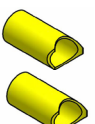
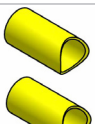
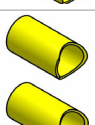
POSTS		
End post Left End post Left - ZC End post Left - SS	DT2600-0001-EPLYE DT2600-0001-EPLYEZ DT2600-0001-EPLYES	
End post Right End post Right - ZC End post Right - SS	DT2600-0001-EPRYE DT2600-0001-EPRYEZ DT2600-0001-EPRYES	
Mid post Mid post - ZC Mid post - SS	DT2600-0001-MPYE DT2600-0001-MPYEZ DT2600-0001-MPYES	
CURVES		
Conn.tube Ø8 Curve 14 in - YE	DT2600-0350-C200YE	
Conn.tube Ø8 - 45° Curve 14 in - YE	DT2600-0350-C204YE	
Conn.tube Ø8 - 90° Curve 14 in - YE	DT2600-0350-C209YE	
Conn.tube Ø10 Curve 14 in - YE	DT2600-0350-C250YE	
Conn.tube Ø10 - 90° Curve 14 in - YE	DT2600-0350-C259YE	

RAIL SETS			
	Tube length (A)	CC length (B)	Reference
Standard rail	26 in	36 in	DT2600-0665-0915YE
Standard rail	38 in	48 in	DT2600-0970-1220YE
Standard rail	50 in	60 in	DT2600-1275-1525YE
Standard rail	62 in	72 in*	DT2600-1578-1828YE
Standard rail	68 in	78 in*	DT2600-1730-1980YE
Short rail	26 - 38 in	36 - 48 in	DT2609-0048-SRYE
Short rail	38 - 50 in	48 - 60 in	DT2609-0060-LRYE
Long rail	50 - 62 in	60 - 72 in*	DT2609-0072-LRYE
Long rail	62 - 68 in	72 - 78 in*	DT2609-0078-LRYE

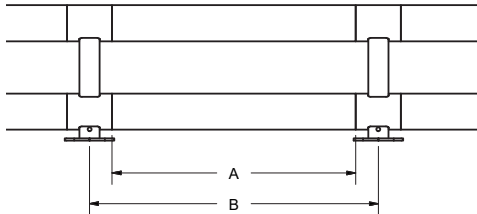

The diagram shows a cross-section of two parallel rails. Dimension A is the distance between the centers of the two rails. Dimension B is the distance between the outer edges of the two rails.

* The impact performance has not been tested for tube lengths > 63 in. Only use these lengths for non - critical applications.



REFERENCE LIST - TB 260 DOUBLE

FIXED UNITS					
TYPE	LENGTH	BASE	YELLOW		
no curves	na	30 in	Steel ZC SS	DT2600-0750-FUYE DT2600-0750-FUYEZ DT2600-0750-FUYES	
		30 - 68 in	Steel ZC SS	DT2601-1750-FUYE DT2601-1750-FUYEZ DT2601-1750-FUYES	
1 curve	Endpost LEFT	30 in	Steel ZC SS	DT2600-0750-FU1CLYE DT2600-0750-FU1CLYEZ DT2600-0750-FU1CLYES	
		30 - 68 in	Steel ZC SS	DT2601-1750-FU1CLYE DT2601-1750-FU1CLYEZ DT2601-1750-FU1CLYES	
	Endpost RIGHT	30 in	Steel ZC SS	DT2600-0750-FU1CRYE DT2600-0750-FU1CRYEZ DT2600-0750-FU1CRYES	
		30 - 68 in	Steel ZC SS	DT2601-1750-FU1CRYE DT2601-1750-FU1CRYEZ DT2601-1750-FU1CRYES	
2 curves	na	32 in	Steel ZC SS	DT2600-0800-FU2CYE DT2600-0800-FU2CYEZ DT2600-0800-FU2CYES	
		32 - 68 in	Steel ZC SS	DT2601-1750-FU2CYE DT2601-1750-FU2CYEZ DT2601-1750-FU2CYES	

SPECSHEET

BOPLAN USA INC | Atlanta, GA | +1 678 890 5906 | sales@boplan.com | www.boplan.com

DISCLAIMER: ALL PRODUCT SPECIFICATIONS AND DATA ARE SUBJECT TO CHANGE WITHOUT NOTICE TO IMPROVE RELIABILITY, FUNCTION OR DESIGN OR OTHERWISE.
 © Boplan, the Boplan logo, Flex Impact and RackBull are trademarks of Boplan bv. All other trademarks are property of their respective owners.