

TB SUPER TRIPLE

SAFETY BARRIERS

Revision: 20 December 2024 8:36 AM
Boplan reference: TS400...

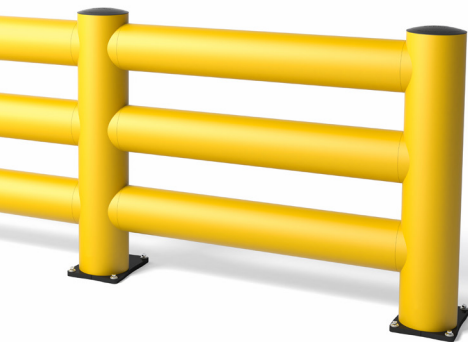

PRODUCT SPECIFICATIONS

APPLICATION			
Environment	The TB Super Triple is the heaviest traffic barrier in the TB series, offering extra-tough collision protection against heavy traffic with a high-impact risk.		
Impact performance at 90°	POST: 44500 Joule (Eq. to 10 ton - 6.6 mph)		
	RAIL: 48300 Joule (Eq. to 10 ton - 7 mph)		
MATERIAL			
Posts and rails	Extrilene® - UV resistant - Fire class E° - Non conductive - Impervious to most chemicals**		
Caps	Sustainable elastomer		
STANDARD COLOURS			
End post	Yellow RAL 1003		
Mid post	Yellow RAL 1003		
Impact tube	Yellow RAL 1003		
BASEPLATES			
	Steel	Zinc Coated Steel	Stainless steel
Material	Steel 37	Steel 37	Stainless steel 304
Coating	Lacquered	Electroplated + Laquered	No lacquer / No coating
Colour	High gloss black	Mat black	Natural colour

*Classification according to EN 13501-1:2007 +A1:2009 - Fire classification of construction products and building elements.

**Ask your local sales office for resistance to specific chemicals.



FIXATIONS				
			ZC (Zinc coated)	SS (Stainless steel)
STANDARD	Wedge anchor		3/4 in x 5 1/2 in	not available
ALTERNATIVES	Wedge anchor		Ø18mm (M12) x 130mm	Ø18mm (M12) x 130mm
	Concrete screw		Ø17mm x 130mm	Not available



FEATURES AND FUNCTIONALITY - TB SUPER TRIPLE

SIZE	
Height end posts	45 in
Height mid post	45 in
Profile section tubes	Ø8 in (2/5 in thick)
Profile section end posts	Outer tube: Ø10 in (2/5 in thick) Inner profile: 4 2/5 x 4 2/5 in (1/3 in)
Profile section mid posts	Outer tube: Ø10 mm (2/5 thick) Inner profile: 4 2/5 x 4 2/5 in (1/3 in)
Standard rail length	CC60 in (Tube length: 50 in)
Baseplate	End Post: 14 3/4 x 10 4/5 (3/4 in thick) Mid Post: 14 3/4 x 10 4/5 (3/4 in thick)

REQUIREMENTS	
Concrete quality	minimum 4000 PSI (C25/30)
Concrete floor plate thickness (mm)	minimum 6 in
Concrete slab dimension around posts (mm)	35 2/5 (H) x 35 2/5 (W) x 23 2/3 (D)
Operational temperature	14 °F up to 104 °F
Water and humidity	Steel (standard): dry indoor use only. Zinc coated : outdoor use in most environments. Stainless Steel : outdoor use or frequent exposure to water and humidity.

 IMPACT LABEL FOR SAFETY BARRIERS		
BOPLAN TB 400 SUPER TRIPLE		
IMPACT RATING	45°	90°
E80	< 80 kJ	
E60	< 60 kJ	
E50	< 50 kJ	
E40	< 40 kJ	
E35	< 35 kJ	
E30	< 30 kJ	
E25	< 25 kJ	
E20	< 20 kJ	
E15	< 15 kJ	
E10	< 10 kJ	
E5	< 5,0 kJ	
E2	< 2,5 kJ	
TEST CONDITIONS	TEST VEHICLE	ACCREDITED TEST LABORATORY
TEMPERATURE: 20°C / 68°F IMPACT HEIGHT: 650 mm / 25 2/3 Inch IMPACT ANGLE: 90° TEST FLOOR: CONCRETE SLAB C25/30 - 160 mm / 6 Inch MANUFACTURER ANCHOR PULL OUT: 17kN	WEIGHT: 2300 KG / 5070.63 lbs TYPE: COMMERCIAL FORK LIFT SIZE (L x W x H): 1890x1020x1970 mm / 74x40x78 Inch CONTACT AREA: STEEL BUMPER WIDTH: 600 mm / 24 Inch	620 Route des Fromentaux 01500 Saint-Maurice-de-Rémens 01360 Bèlignieux France 
SUCCESS CRITERIA VEHICLE STOPPED - ASI (ACCELERATION SEVERITY INDEX) <0.5		IL-TS400-20230705

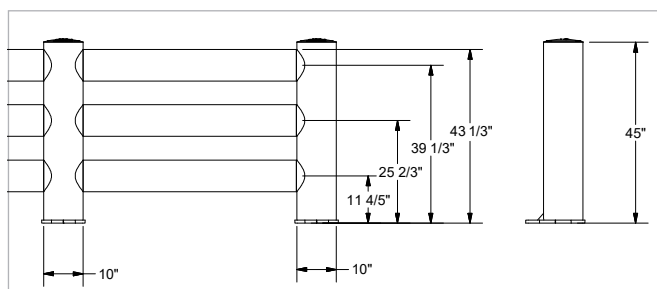
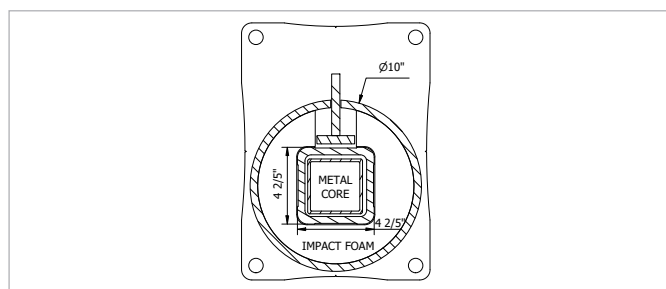
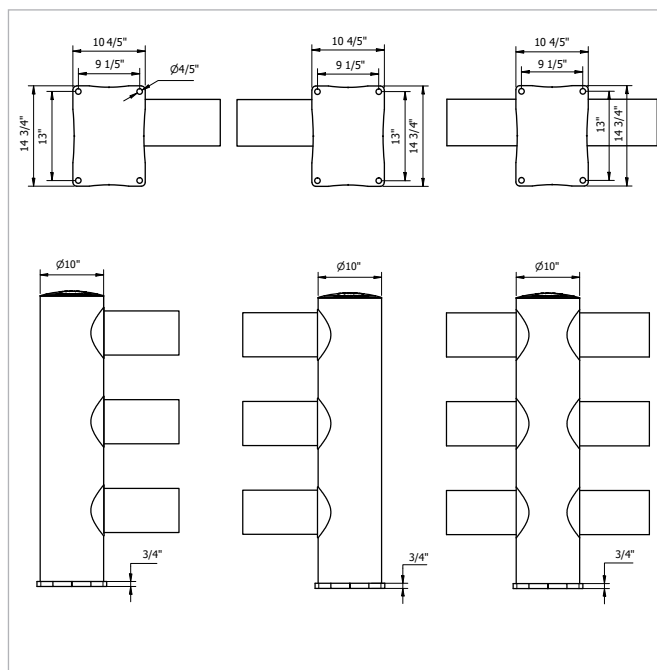

REFERENCE LIST - TB SUPER TRIPLE

POSTS

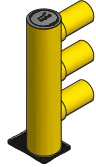
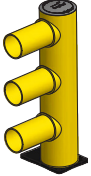
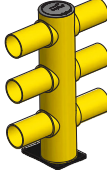
End post Left End post Left - ZC End post Left - SS	TS4000-0001-EPLYE TS4000-0001-EPLYEZ TS4000-0001-EPLYES	
End post Right End post Right - ZC End post Right - SS	TS4000-0001-EPRYE TS4000-0001-EPRYEZ TS4000-0001-EPRYES	
Mid post Mid post - ZC Mid post - SS	TS4000-0001-MPYE TS4000-0001-MPYEZ TS4000-0001-MPYES	

CURVES

Conn.tube Ø8 Curve 14 in - YE	TS4000-0350-C200YE	
Conn.tube Ø8 - 45° Curve 14 in - YE	TS4000-0350-C204YE	
Conn.tube Ø8 - 90° Curve 14 in - YE	TS4000-0350-C209YE	
Conn.tube Ø10 Curve 14 in - YE	TS4000-0350-C250YE	
Conn.tube Ø10 - 90° Curve 14 in - YE	TS4000-0350-C259YE	

RAIL SETS

	Tube length (A)	CC length (B)	Reference
Standard rail	26 in	36 in	TS4000-0655-0915YE
Standard rail	38 in	48 in	TS4000-0970-1220YE
Standard rail	50 in	60 in	TS4000-1275-1525YE
Standard rail	62 in	72 in	TS4000-1578-1828YE
Standard rail	68 in	78 in*	TS4000-1730-1980YE
Short rail	26 - 38 in	36 - 48 in	TS4009-0048-SRYE
Long rail	38 - 50 in	48 - 60 in	TS4009-0060-LRYE
Long rail	50 - 62 in	60 - 72 in*	TS4009-0072-LRYE
Long rail	62 - 68 in	72 - 78 in*	TS4009-0078-LRYE

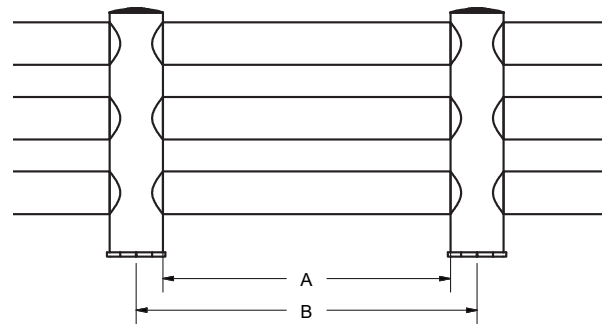

* The impact performance has not been tested for tube lengths > 63 in.
Only use these lengths for non - critical applications.

REFERENCE LIST - TB SUPER TRIPLE

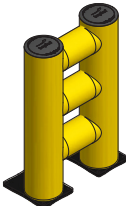
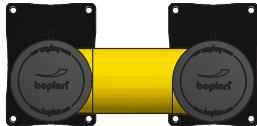
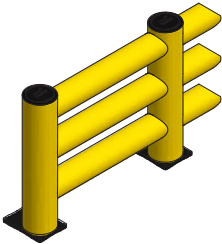
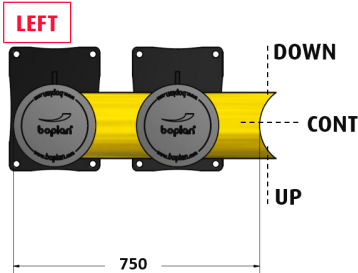
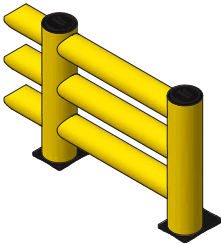
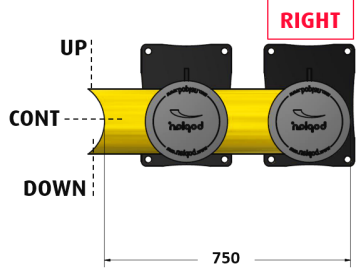
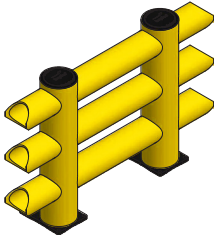
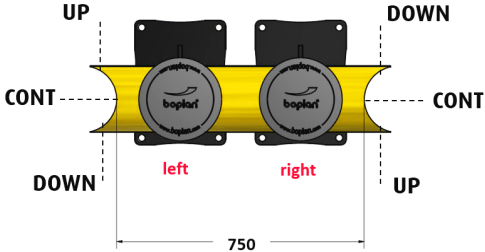
FIXED UNITS						
TYPE	LENGTH		BASE	REFERENCE YE		
no curves	30 in		Steel ZC SS	TS4000-0750-FUYE TS4000-0750-FUYEZ TS4000-0750-FUYES		
	30-68 in		Steel ZC SS	TS4001-1750-FUYE TS4001-1750-FUYEZ TS4001-1750-FUYES		
1 curve	Post LEFT	30 in	Steel ZC SS	TS4000-0750-FU1CLYE TS4000-0750-FU1CLYEZ TS4000-0750-FU1CLYES		
		30-68 in	Steel ZC SS	TS4001-1750-FU1CLYE TS4001-1750-FU1CLYEZ TS4001-1750-FU1CLYES		
	Post RIGHT	30 in	Steel ZC SS	TS4000-0750-FU1CRYE TS4000-0750-FU1CRYEZ TS4000-0750-FU1CRYES		
		30-68 in	Steel ZC SS	TS4001-1750-FU1CRYE TS4001-1750-FU1CRYEZ TS4001-1750-FU1CRYES		
2 curves	32 in		Steel ZC SS	TS4000-0800-FU2CYE TS4000-0800-FU2CYEZ TS4000-0800-FU2CYES		
	32-68 in		Steel ZC SS	TS4001-1750-FU2CYE TS4001-1750-FU2CYEZ TS4001-1750-FU2CYES		