

# DOCK GATE FORCE

# SAFETY GATES

Revision: 6 June 2024 2:43 PM  
Boplan reference: DG2500...

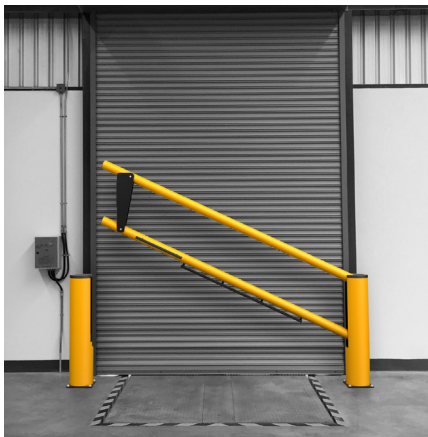

## PRODUCT SPECIFICATIONS

APPLICATION	
Protection	Double rail safety gate up to 3 meter.
Environment	Around loading docks Around loading pits
Features	Up to 3 meter wide Compact design, no loss of space Soft close system - closing speed dependant on gate size (5 to 10 seconds) Effortless opening and closing Integrated shutter mechanism for limited finger trap hazard Flexible and impact resistant rail and post system UV resistant No maintenance required Reinforced version of the Dock Gate
MATERIAL	
Housing	Extrilene® - UV resistant - Fire class E <sup>+</sup> - Non conductive - Impervious to most chemicals**
Caps	Sustainable elastomer
Baseplate and internal parts	Zinc coated steel / aluminum
STANDARD COLOURS	
Posts	Standard: Yellow RAL 1003
Rails	Standard: Yellow RAL 1003
Caps and visible metals	Standard: Black RAL 9005

\*Classification according to EN 13501-1:2007 +A1:2009 - Fire classification of construction products and building elements.  
\*\*Ask your local sales office for resistance to specific chemicals.





FIXATIONS			
		ZC (Zinc coated)	SS (Stainless steel)
STANDARD	Concrete screw	 Ø12mm x 100mm	Not available
	Anchor rod (Chemical)	 M12 x 120mm + Chemical resin	Not available
ALTERNATIVES	Asphalt anchor	 Bolt M10 x 40mm + Screw Ø16mm	Not available
	Spit anchor	 Bolt M12 x 100mm + Plug Ø20mm	Not available



## FEATURES AND FUNCTIONALITY - DOCK GATE FORCE

SIZE	
Height posts	1175 mm
Profile section tubes	Ø100 mm (8 mm thick)
Profile section posts	Ø250 mm (11 mm thick)
Baseplate	275 mm x 275 mm (10 mm thick)

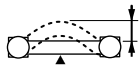
REQUIREMENTS	
Concrete quality	minimum C25/30
Concrete floor plate thickness (mm)	minimum 150 mm
Concrete slab dimension around posts (mm)	600 (h) x 600 (w) x 500 (d)
Operational temperature	0°C up to +40°C
Water and humidity	Use indoors or in occasionally wet locations

 <b>IMPACT LABEL FOR SAFETY BARRIERS</b>																									
<b>BOPLAN DOCK GATE FORCE</b>																									
<b>IMPACT RATING</b>	90°																								
<table border="0"> <tr><td><b>E50</b></td><td>&lt; 50 kJ</td></tr> <tr><td><b>E40</b></td><td>&lt; 40 kJ</td></tr> <tr><td><b>E30</b></td><td>&lt; 30 kJ</td></tr> <tr><td><b>E25</b></td><td>&lt; 25 kJ</td></tr> <tr><td><b>E20</b></td><td>&lt; 20 kJ</td></tr> <tr><td><b>E15</b></td><td>&lt; 15 kJ</td></tr> <tr><td><b>E12</b></td><td>&lt; 12 kJ</td></tr> <tr><td><b>E10</b></td><td>&lt; 10 kJ</td></tr> <tr><td><b>E7</b></td><td>&lt; 7.5 kJ</td></tr> <tr><td><b>E5</b></td><td>&lt; 5.0 kJ</td></tr> <tr><td><b>E2</b></td><td>&lt; 2.5 kJ</td></tr> <tr><td><b>E1</b></td><td>&lt; 1.0 kJ</td></tr> </table>	<b>E50</b>	< 50 kJ	<b>E40</b>	< 40 kJ	<b>E30</b>	< 30 kJ	<b>E25</b>	< 25 kJ	<b>E20</b>	< 20 kJ	<b>E15</b>	< 15 kJ	<b>E12</b>	< 12 kJ	<b>E10</b>	< 10 kJ	<b>E7</b>	< 7.5 kJ	<b>E5</b>	< 5.0 kJ	<b>E2</b>	< 2.5 kJ	<b>E1</b>	< 1.0 kJ	
<b>E50</b>	< 50 kJ																								
<b>E40</b>	< 40 kJ																								
<b>E30</b>	< 30 kJ																								
<b>E25</b>	< 25 kJ																								
<b>E20</b>	< 20 kJ																								
<b>E15</b>	< 15 kJ																								
<b>E12</b>	< 12 kJ																								
<b>E10</b>	< 10 kJ																								
<b>E7</b>	< 7.5 kJ																								
<b>E5</b>	< 5.0 kJ																								
<b>E2</b>	< 2.5 kJ																								
<b>E1</b>	< 1.0 kJ																								
<b>IMPACT RESULTS</b> Deflection: At maximum impact energy  D= 1086 mm / 42.8 inch	<b>SUCCESS CRITERIA</b> VEHICLE STOPPED ASI (ACCELERATION SEVERITY INDEX) <0.5																								
<b>TEST CONDITIONS</b> TEMPERATURE: 20°C / 68°F IMPACT ON MIDDLE OF RAILS IMPACT HEIGHT: 520 mm / 20.5 Inch TEST FLOOR: CONCRETE SLAB C25/30 - 150 mm / 6 Inch	<b>BOPLAN TEST LAB</b> Muizelstraat 12 8560 Moorsele Belgium 																								
<b>TEST VEHICLE:</b> TYPE: BOPLAN IMPACT TEST VEHICLE WEIGHT: 3775 Kg / 8322.45 lbs SIZE (L x W x h): 3100 x 1100 x 1150 mm / 122 x 43.3 x 45.3 Inch CONTACT AREA, STEEL BUMPER WIDTH: 1000 mm / 39.4 Inch	Approved by: <b>TÜV NORD Systems</b> PAS 13:2017 compliant 																								
<b>IL-DGFORCE-20221222</b>																									

\* The impact performance has not been tested for gate sizes (inner width)W ≠ 1800 mm.

## REFERENCE LIST - DOCK GATE FORCE

Reference	Description	Inner width (L)	Height when open (H)	Weight
DG2500-1800-S201YEZ	Dock gate force 1800 - YE - ZC - (including 2 posts)	1800 mm	3245 mm	91,3 kg
DG2500-2100-S201YEZ	Dock gate force 2100 - YE - ZC - (including 2 posts)	2100 mm	3545 mm	91,8 kg
DG2500-2400-S201YEZ	Dock gate force 2400 - YE - ZC - (including 2 posts)	2400 mm	3845 mm	94,4 kg
DG2500-2700-S201YEZ	Dock gate force 2700 - YE - ZC - (including 2 posts)	2700 mm	4145 mm	95,7 kg
DG2500-3000-S201YEZ	Dock gate force 3000 - YE - ZC - (including 2 posts)	3000 mm	4445 mm	97,2 kg

## DRAWING AND DIMENSIONS - DOCK GATE FORCE

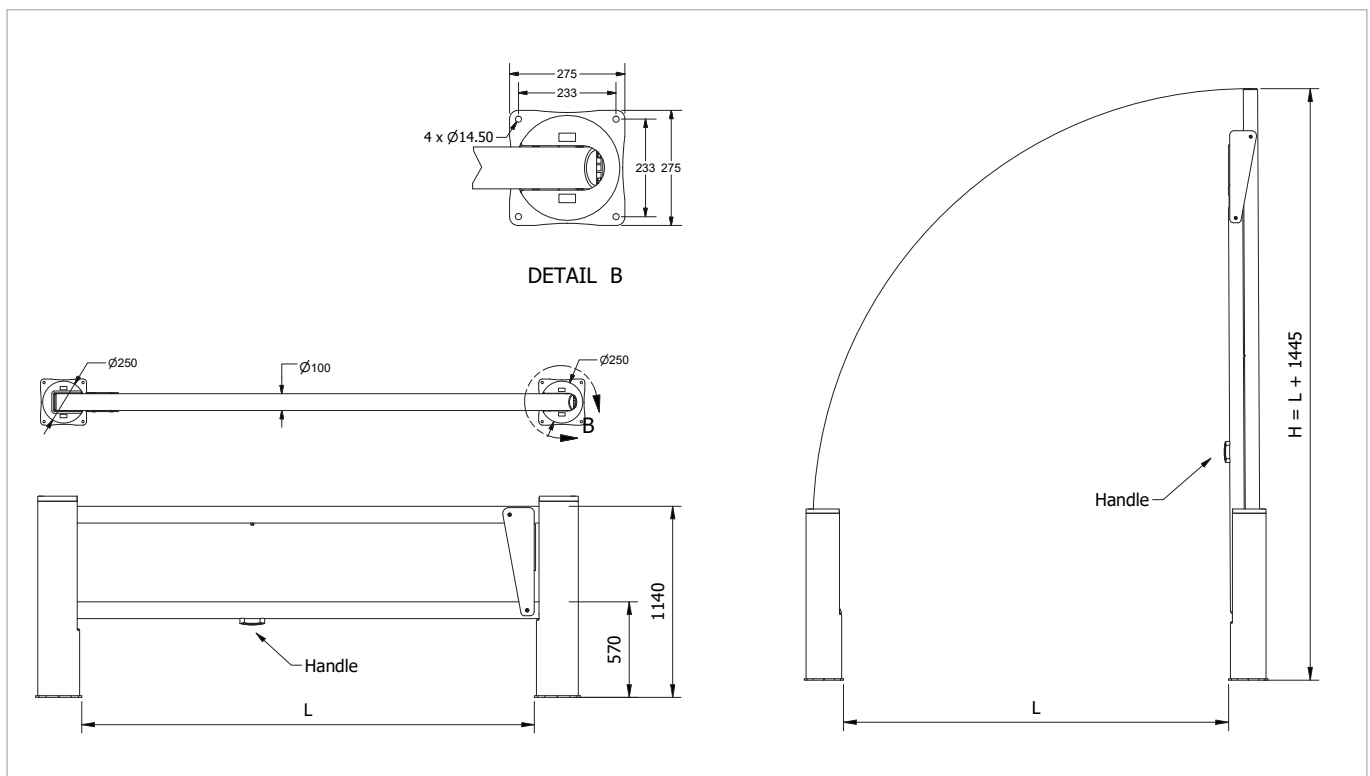

## COMPLIANCE

Designed to meet OSHA <sup>*</sup> requirements	The top edge height of top rail 110cm is above the walking surface	✓
	The midrail is at 50cm above walking surface	✓
	The gate is capable of withstanding 90 kg force applied in a downward or outward direction. The deflection during the test of the top rail may not cause the top rail to be lower than 99cm above walking surface.	✓
	No sharp edges; smooth surface	✓

\* OSHA 1910.29 B Fall protection systems and falling object protection-criteria and practices.