

TB 260 PLUS

SAFETY BARRIERS

Revision: 10 February 2025 11:12 AM
Boplan reference: TP2600-...



PRODUCT SPECIFICATIONS

APPLICATION

Environment	The TB 260 Plus is used for creating walkways and protecting pedestrians from pallet trucks, lift trucks, forklifts or other vehicles. The lower tube prevents goods or pallets sliding under the barriers and hitting pedestrians or causing damage to machines or equipment.
Impact performance at 90°	POST: 12000 Joule (Eq. to 5 ton - 5 mph)
	RAIL: 21200 Joule (Eq. to 5 ton - 6.5 mph)

MATERIAL

Posts and rails	Extrilene® - UV resistant - Fire class E ⁺ - Non conductive - Impervious to most chemicals ^{**}
Caps	Sustainable elastomer

STANDARD COLOURS

End post	Black RAL 9005
Mid post	Black RAL 9005
Impact tube	Yellow RAL 1003
Handrails	Yellow RAL 1003

BASEPLATES

	Steel	Zinc Coated Steel	Stainless steel
Material	Steel 37	Steel 37	Stainless steel 304
Coating	Lacquered	Electroplated + Laquered	No lacquer / No coating
Colour	High gloss black	Mat black	Natural colour

*Classification according to EN 13501-1:2007 +A1:2009 - Fire classification of construction products and building elements.

**Ask your local sales office for resistance to specific chemicals.

FIXATIONS

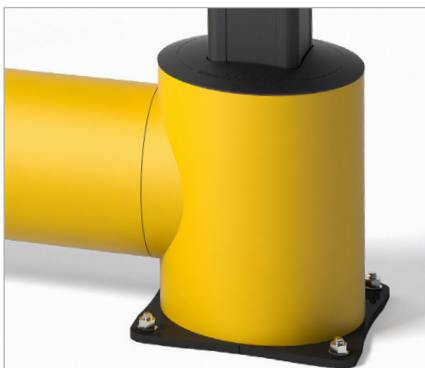

		ZC (Zinc coated)	SS (Stainless steel)
STANDARD	Wedge anchor	 1/2 in x 4 1/2 in	Not available
	Wedge anchor	 M12 x 120 mm	M12 x 120 mm
ALTERNATIVES	Anchor rod (Chemical)	 M12 x 120 mm + Chemical resin	M12 x 120 mm + Chemical resin
	Asphalt anchor	 Bolt M10 x 40 mm + Screw Ø16 mm	Not available
	Spit anchor	 Bolt M12 x 100 mm + Plug Ø20 mm	Not available



FEATURES AND FUNCTIONALITY - TB 260 PLUS

SIZE	
Height end posts	45 1/3 in
Height mid post	45 1/3 in
Profile section tubes	Ø8 in (2/5 in thick)
Profile section handrails	2 x 2 3/4 in (1/5 in thick)
Profile section end posts	Outer tube: Ø10 in (2/5 in thick) Inner profile: 4 2/5 x 4 2/5 in (1/3 in thick)
Profile section mid posts	Profile: 4 2/5 x 4 2/5 in (1/3 in thick)
Standard rail length	CC60 in (Tube length - 50 in)
Baseplate	End Post: 10 4/5 x 10 4/5 x (1/3 in thick) Mid Post: 7 x 7 x (1/3 in thick)

REQUIREMENTS	
Concrete quality	minimum 4000 pSI (C25/30)
Concrete floor plate thickness	minimum 6 in
Concrete slab dimension around posts (in)	23 2/3 (h) x 23 2/3 (w) x 11 4/5 (d)
Operational temperature	14°F up to 104°F
Water and humidity	Steel (standard): dry indoor use only. Zinc coated: outdoor use in most environments. Stainless Steel: outdoor use or frequent exposure to water and humidity.

boplan® IMPACT LABEL FOR SAFETY BARRIERS		
BOPLAN TB 260 PLUS		
IMPACT RATING	45°	90°
E80	< 80 kJ	
E60	< 60 kJ	
E50	< 50 kJ	
E40	< 40 kJ	
E35	< 35 kJ	30,0 kJ
E30	< 30 kJ	
E25	< 25 kJ	21,2 kJ
E20	< 20 kJ	
E15	< 15 kJ	
E10	< 10 kJ	
E5	< 5,0 kJ	
E2	< 2,5 kJ	
TEST CONDITIONS TEMPERATURE: 20°C / 68°F IMPACT HEIGHT: 160 mm / 6 1/4 Inch IMPACT ANGLE: 90° TEST FLOOR: CONCRETE SLAB C25/30 - 160 mm / 6 inch MANUFACTURER ANCHOR PULL OUT: 7,9 kN	TEST VEHICLE WEIGHT: 2300 KG / 5070.63 lbs TYPE: COMMERCIAL FORK LIFT SIZE (L x W x H): 1890x1020x1970 mm / 74x40x78 Inch CONTACT AREA: STEEL BUMPER WIDTH: 600 mm / 24 Inch	ACCREDITED TEST LABORATORY  620 Route des Fromentaux 01500 Saint-Maurice-de-Rémens 01360 Bèlignieux France IL-TP260-20250103
SUCCESS CRITERIA VEHICLE STOPPED - ASI (ACCELERATION SEVERITY INDEX) < 0.5		

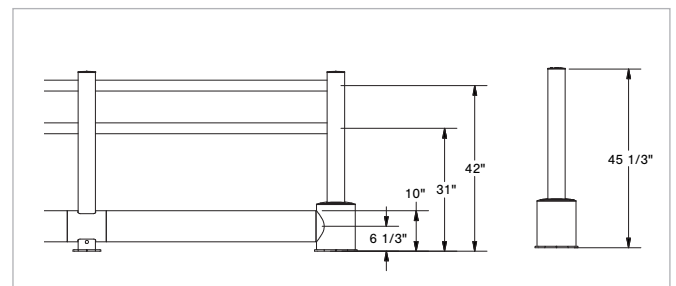
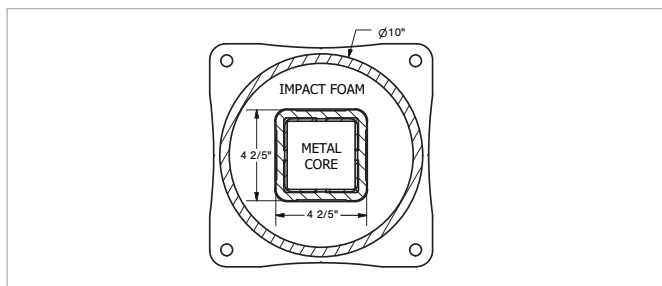
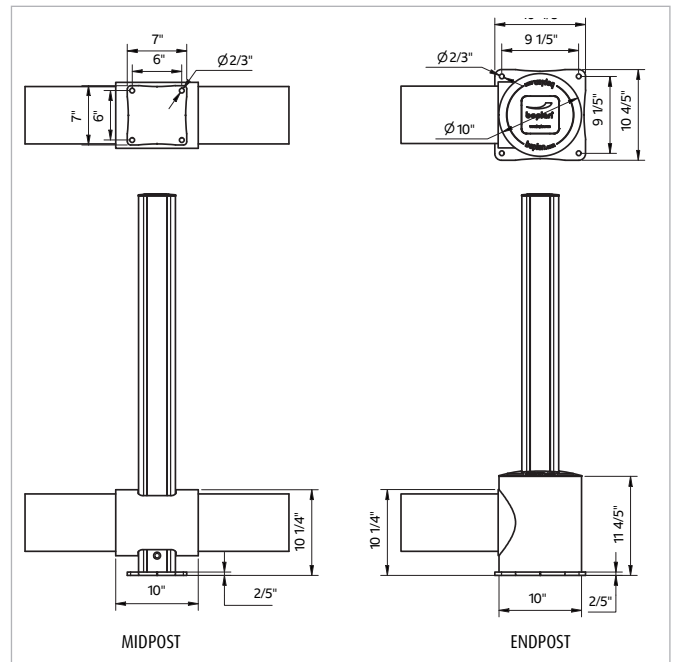

REFERENCE LIST - TB 260 PLUS

POSTS		
End post End post - ZC End post - SS	TP2600-0001-EPYE TP2600-0001-EPYEZ TP2600-0001-EPYES	
Mid post Mid post - ZC Mid post - SS	TP2600-0001-MPYE TP2600-0001-MPYEZ TP2600-0001-MPYES	
T end post* T end post - ZC* T end post - SS*	TP2600-0001-TPYE TP2600-0001-TPYEZ TP2600-0001-TPYES	
Corner post - 90° - Up Corner post - 90° - Up - ZC Corner post - 90° - Up - SS	TP2600-0001-CPUYE TP2600-0001-CPUYEZ TP2600-0001-CPUYES	
Corner post - 90° - Down Corner post - 90° - Down - ZC Corner post - 90° - Down - SS	TP2600-0001-CPDYE TP2600-0001-CPDYEZ TP2600-0001-CPDYES	

* 2 caps included to close handrail hole

CURVES		
Conn.tube Ø8 in Curve 14 in - YE	TP2600-0014-C080YE	
Conn.tube Ø8 in - 45° Curve 14 in - YE	TP2600-0014-C084YE	
Conn.tube Ø8 - 90° Curve 14 in - YE	TP2600-0014-C089YE	
Conn.tube Ø10 Curve 14 in - YE	TP2600-0014-C100YE	
Conn.tube Ø10 - 90° Curve 14 in - YE	TP2600-0014-C109YE	

RAIL SETS			
	Tube length (A)	CC length (B)	Reference
Standard rail	26 in	36 in	TB2600-0665-0915YE
Standard rail	32 in	42 in	TB2600-0817-1067YE
Standard rail	38 in	48 in	TB2600-0970-1220YE
Standard rail	50 in	60 in	TB2600-1275-1525YE
Standard rail	62 in	72 in*	TB2600-1578-1828YE
Standard rail	68 in	78 in*	TB2600-1730-1980YE
Short rail	26 - 38 in	36 - 48 in	TB2609-0048-SRYE
Long rail	50 - 62 in	60 - 72 in*	TB2609-0072-LRYE

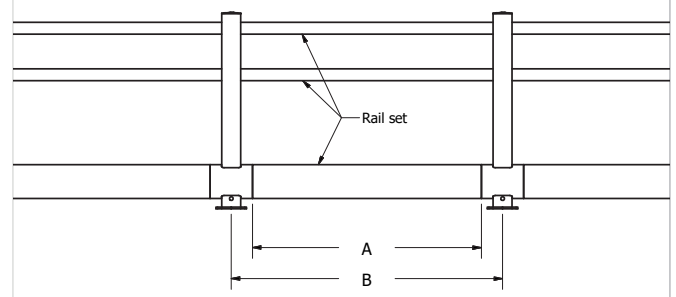

* The impact performance has not been tested for tube lengths > 63 in.
Only use these lengths for non - critical applications.

REFERENCE LIST - TB 260 PLUS

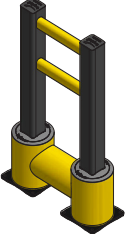
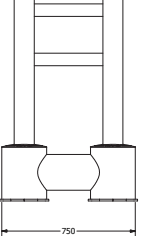
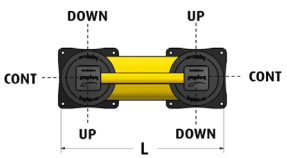
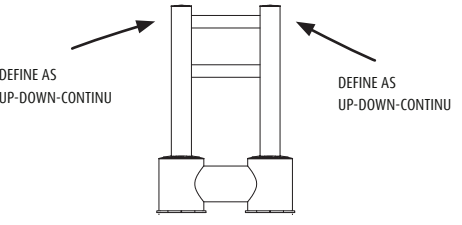
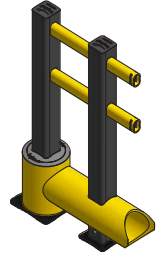
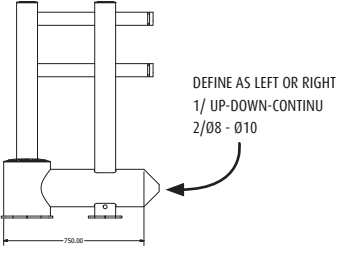
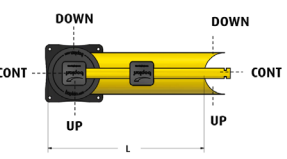
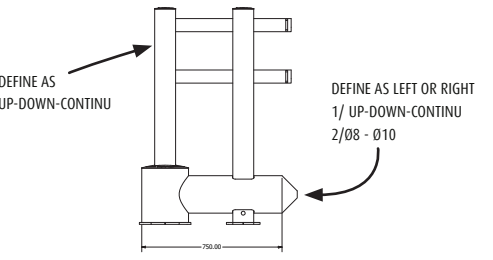
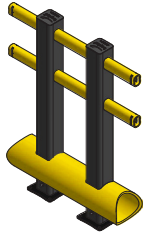
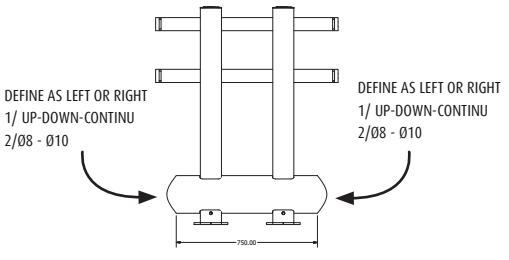
FIXED UNITS					
TYPE	LENGTH	BASE	REFERENCE YE		
no curves	Endpost	30 in	Steel ZC SS TP2600-0750-FUYE TP2600-0750-FUYEZ TP2600-0750-FUYES		
		30 - 68 in	Steel ZC SS TP2601-1750-FUYE TP2601-1750-FUYEZ TP2601-1750-FUYES		
	Post <i>Up</i> <i>Down</i> <i>Continu</i>	30 in	Steel ZC SS TP2602-0750-FUYE TP2602-0750-FUYEZ TP2602-0750-FUYES		
		30 - 68 in	Steel ZC SS TP2602-1750-FUYE TP2602-1750-FUYEZ TP2602-1750-FUYES		
1 curve	Endpost	30 in	Steel ZC SS TP2600-0750-FU1CYE TP2600-0750-FU1CYEZ TP2600-0750-FU1CYES		
		30 - 68 in	Steel ZC SS TP2601-1750-FU1CYE TP2601-1750-FU1CYEZ TP2601-1750-FU1CYES		
	Post <i>Up</i> <i>Down</i> <i>Continu</i>	30 in	Steel ZC SS TP2602-0750-FU1CYE TP2602-0750-FU1CYEZ TP2602-0750-FU1CYES		
		30 - 68 in	Steel ZC SS TP2602-1750-FU1CYE TP2602-1750-FU1CYEZ TP2602-1750-FU1CYES		
2 curves	-	30 in	Steel ZC SS TP2600-0750-FU2CYE TP2600-0750-FU2CYEZ TP2600-0750-FU2CYES		
		30 - 68 in	Steel ZC SS TP2601-1750-FU2CYE TP2601-1750-FU2CYEZ TP2601-1750-FU2CYES		

REFERENCE LIST - TB 260 PLUS

FIXED UNITS

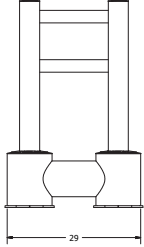
	TYPE	LENGTH	BASE	REFERENCE RE		
no curves	Endpost	29 in	Steel	TP2600-0750-FURE		
		30-69 in	Steel	TP2601-1750-FURE		

