

# BO SLEEVE

## ACCESSORIES

Revision: 30 May 2024 5:03 PM  
Boplan reference: BS...

### PRODUCT SPECIFICATIONS

APPLICATION	
Environment	Polymer sleeve that can be slid over existing bollards.
MATERIAL	
Tube	Extrilene® - UV resistant - Fire class E <sup>+</sup> - Non conductive - Impervious to most chemicals**
COLOURS	
Sleeve	Standard: Yellow RAL 1003 Also available in Black RAL 9005 (Multicolour)
BASEPLATES	
No baseplate	
FIXATIONS	
No fixations	

\*Classification according to EN 13501-1:2007 +A1:2009 - Fire classification of construction products and building elements.  
\*\*Ask your local sales office for resistance to specific chemicals.



**REFERENCE LIST - BO SLEEVE**

**Sleeve 125x105**

Advised application diameter **90 mm - 100 mm**

H: 500-1000 mm  
YELLOW      BS1251-1000-0001YE

H: 500-1000 mm  
Multicolour (BL)      BS1251-1000-0001MC

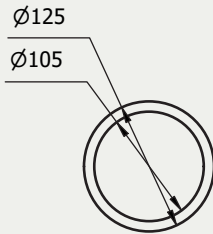

**Sleeve 200X178**

Advised application diameter **165 mm - 175 mm**

H: 500-1200 mm  
YELLOW      BS2001-1200-0001YE

H: 500-1200 mm  
Multicolour (BL)      BS2001-1200-0001MC

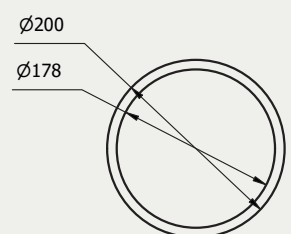

**Sleeve 225x204**

Advised application diameter **200 mm** (Perfect fit for Boplan BO200R and BO200F)

H: 160-400 mm  
YELLOW      BS2251-0400-0001YE

H: 500-1200 mm  
YELLOW      BS2251-1200-0001YE

H: 170 mm  
YELLOW      BS2250-0170-0001YE

H: 400 mm  
YELLOW      BS2250-0400-0001YE

H: 555 mm  
YELLOW      BS2250-0555-0001YE

H: 555 mm  
Multicolour (BL)      BS2250-0555-0001MC

H: 805 mm  
YELLOW      BS2250-0805-0001YE

H: 805 mm  
Multicolour (BL)      BS2250-0805-0001MC

H: 1005 mm  
YELLOW      BS2250-1005-0001YE

H: 1005 mm  
Multicolour (BL)      BS2250-1005-0001MC

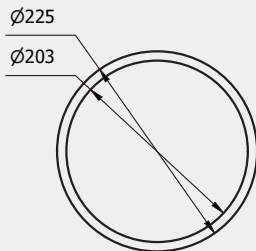

**Sleeve 250X228**

Advised application diameter **215 mm - 225 mm**

H: 500-1200 mm  
YELLOW      BS2501-1200-0001YE

H: 500-1200 mm  
Multicolour (BL)      BS2501-1200-0001MC

