

TB 260 DOUBLE

SAFETY BARRIERS

Revision: 30 January 2026 10:12 AM
Boplan reference: DT260...



PRODUCT SPECIFICATIONS

APPLICATION			
Environment	A double traffic barrier that closely resembles a guardrail which goes the extra mile in shielding pedestrians from vehicle collisions. The lower centre of gravity provides extra strength.		
Impact performance at 90°	POST: 39800 Joule (Eq. to 10 ton - 10,2 km/h)		
	RAIL: 46500 Joule (Eq. to 10 ton - 11,0 km/h)		
MATERIAL			
Posts and rails	Extrilene® - UV resistant - Fire class E ⁺ - Non conductive - Impervious to most chemicals ^{**}		
Caps	Sustainable elastomer		
STANDARD COLOURS			
End post	Yellow RAL 1003		
Mid post	Yellow RAL 1003		
Impact tube	Yellow RAL 1003		
BASEPLATES			
	Steel	Zinc Coated Steel	Stainless steel
Material	Steel 37	Steel 37	Stainless steel 304
Coating	Lacquered	Electroplated + Lacquered	No lacquer / No coating
Colour	High gloss black	Mat black	Natural colour

*Classification according to EN 13501-1:2007 +A1:2009 - Fire classification of construction products and building elements.

**Ask your local sales office for resistance to specific chemicals.

FIXATIONS

			ZC (Zinc coated)	SS (Stainless steel)
STANDARD	Wedge anchor		Ø18mm (M12) x 130mm	Ø18mm (M12) x 130mm
	Anchor rod (Chemical)		M16 x 120mm + Chemical resin	M16 x 120mm + Chemical resin
ALTERNATIVES	Concrete screw		Ø17mm x 130mm	Not available

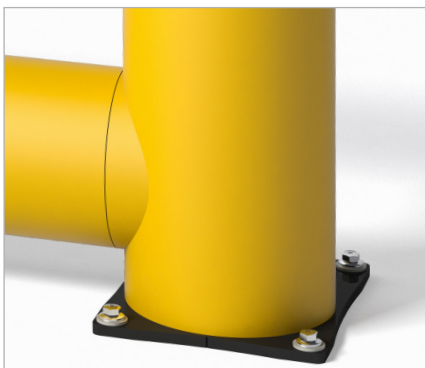

FEATURES AND FUNCTIONALITY - TB 260 DOUBLE

SIZE	
Height end posts	790 mm
Height mid post	750 mm
Profile section tubes	Ø200 mm (11 mm thick)
Profile section end posts	Outer tube: Ø250 mm (11 mm thick) Inner profile: 112 mm x 112 mm (10 mm thick)
Profile section mid posts	Profile: 112 mm x 112 mm (10 mm thick)
Standard rail length	1350 mm (other sizes: 750 mm - 1750 mm)
Baseplate	End Post: 275 mm x 320 mm (12mm thick) Mid Post: 275 mm x 320 mm (12mm thick)

REQUIREMENTS	
Concrete quality	minimum C25/30
Concrete floor plate thickness	minimum 150 mm
Concrete slab dimension around posts (mm)	800 (h) x 800 (w) x 600 (d)
Operational temperature	-10°C up to +40°C
Water and humidity	Steel (standard): dry indoor use only. Zinc coated: outdoor use in most environments. Stainless Steel: outdoor use or frequent exposure to water and humidity.

IMPACT LABEL FOR SAFETY BARRIERS

BOPLAN TB 260 Double		
IMPACT RATING	45°	90°
E80 < 80 kJ	65,7 kJ	
E60 < 60 kJ		
E50 < 50 kJ		
E40 < 40 kJ		46,5 kJ
E35 < 35 kJ		
E30 < 30 kJ		
E25 < 25 kJ		
E20 < 20 kJ		
E15 < 15 kJ		
E10 < 10 kJ		
E5 < 5,0 kJ		
E2 < 2,5 kJ		

TEST CONDITIONS

TEMPERATURE: 20°C / 68°F

IMPACT HEIGHT: 650 mm / 25 2/3 Inch

IMPACT ANGLE: 90°

TEST FLOOR: CONCRETE SLAB C25/30 - 160 mm / 6 Inch

MANUFACTURER ANCHOR PULL OUT: 17kN

TEST VEHICLE

WEIGHT: 2300 KG / 5070.63 lbs

TYPE: COMMERCIAL FORK LIFT

SIZE (L x W x H): 1890x1020x1970 mm / 74x40x78 Inch

CONTACT AREA: STEEL BUMPER WIDTH: 600 mm / 24 Inch

ACCREDITED TEST LABORATORY

620 Route des Fromentaux

01500 Saint-Maurice-de-Rémens

01360 Bèligenieux

France

SUCCESS CRITERIA VEHICLE STOPPED - ASI (ACCELERATION SEVERITY INDEX) < 0.5

IL-DT260-20230710

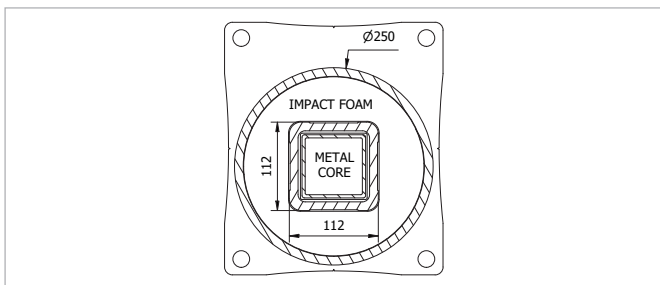
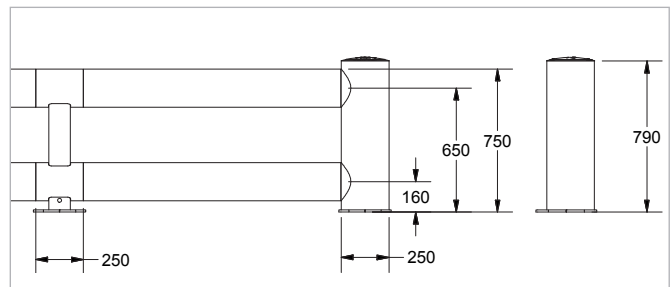
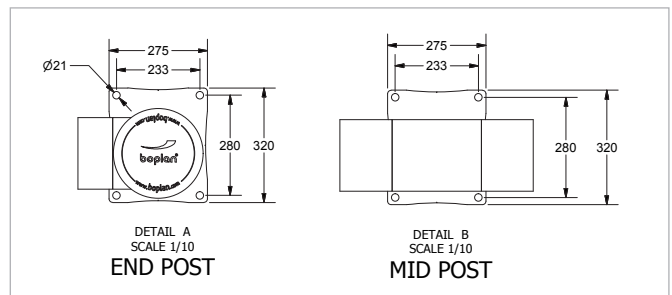

REFERENCE LIST - TB 260 DOUBLE

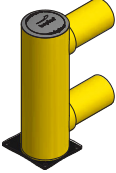
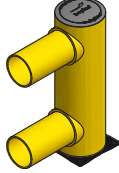
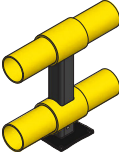
POSTS		
End post Left End post Left - ZC End post Left - SS	DT2600-0001-EPLYE DT2600-0001-EPLYEZ DT2600-0001-EPLYES	
End post Right End post Right - ZC End post Right - SS	DT2600-0001-EPRYE DT2600-0001-EPRYEZ DT2600-0001-EPRYES	
Mid post Mid post - ZC Mid post - SS	DT2600-0001-MPYE DT2600-0001-MPYEZ DT2600-0001-MPYES	

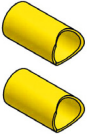
CURVES		
Conn.tube Ø250 Curve 350mm - YE	DT2600-0350-C250YE	
Conn.tube Ø250 - 90° Curve 350mm - YE	DT2600-0350-C259YE	

RAIL SETS			
	Tube length (A)	CC length (B)	Reference
Standard rail	750 mm	1000 mm	DT2600-0750-1000YE
Standard rail	950 mm	1200 mm	DT2600-0950-1200YE
Standard rail	1150 mm	1400 mm	DT2600-1150-1400YE
Standard rail	1350 mm	1600 mm	DT2600-1350-1600YE
Standard rail	1550 mm	1800 mm*	DT2600-1550-1800YE
Standard rail	1750 mm	2000 mm*	DT2600-1750-2000YE
Short rail	600-1349 mm	850-1599 mm	DT2609-1599-SRYE
Long rail	1351-1749 mm	1601-2000 mm*	DT2609-2000-LRYE

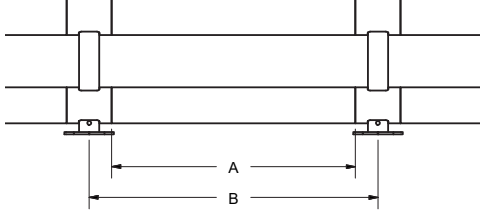

The diagram shows a cross-section of two parallel rails. Dimension A is the distance between the centers of the two rails. Dimension B is the distance between the outer edges of the two rails.

* The impact performance has not been tested for tube lengths > 1600 mm.
Only use these lengths for non - critical applications.

REFERENCE LIST - TB 260 DOUBLE

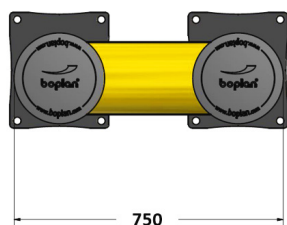
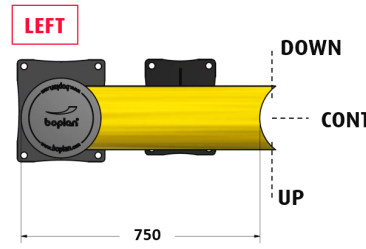
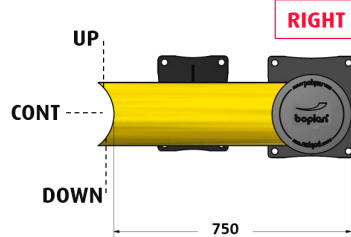
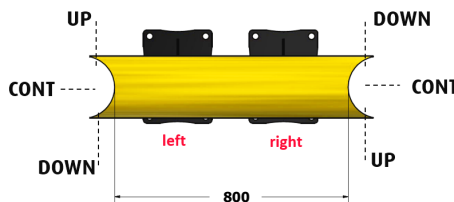
FIXED UNITS					
TYPE	LENGTH	BASE	REFERENCE YE		
no curves	na	750 mm	Steel ZC SS	DT2600-0750-FUYE DT2600-0750-FUYEZ DT2600-0750-FUYES	
		751-1750 mm	Steel ZC SS	DT2601-1750-FUYE DT2601-1750-FUYEZ DT2601-1750-FUYES	
1 curve	Endpost LEFT	750 mm	Steel ZC SS	DT2600-0750-FU1CLYE DT2600-0750-FU1CLYEZ DT2600-0750-FU1CLYES	
		751-1750 mm	Steel ZC SS	DT2601-1750-FU1CLYE DT2601-1750-FU1CLYEZ DT2601-1750-FU1CLYES	
	Endpost RIGHT	750 mm	Steel ZC SS	DT2600-0750-FU1CRYE DT2600-0750-FU1CRYEZ DT2600-0750-FU1CRYES	
		751-1750 mm	Steel ZC SS	DT2601-1750-FU1CRYE DT2601-1750-FU1CRYEZ DT2601-1750-FU1CRYES	
2 curves	na	800 mm	Steel ZC SS	DT2600-0800-FU2CYE DT2600-0800-FU2CYEZ DT2600-0800-FU2CYES	
		801-1750 mm	Steel ZC SS	DT2601-1750-FU2CYE DT2601-1750-FU2CYEZ DT2601-1750-FU2CYES	