

# TB 400 DOUBLE GRILL BARRIER

## SAFETY BARRIERS



Revision: 6 February 2026 4:13 PM  
Boplan reference: GD4...



### PRODUCT SPECIFICATIONS

APPLICATION	
Environment	Extremely robust, double traffic barrier for collision protection against heavy vehicles and (falling) goods. The TB double-tube guardrail offers pedestrians increased safety in storage areas with a lot of forklift traffic. Depending on the size of the (stacked) goods, one can opt for an arrangement with a centre distance between the rails of 11 in. Intended for indoor use.
MATERIAL	
Posts and rails	Extrilene - UV resistant - Fire class E <sup>®</sup> - Non conductive - Impervious to most chemicals <sup>**</sup>
STANDARD COLORS	
End post	Black RAL 9005
Mid post	Black RAL 9005
Impact tube	Yellow RAL 1003
Handrails	Yellow RAL 1003
BASEPLATES	
	Steel
Material	Steel 37
Coating	Lacquered
Color	High gloss black

\*Classification according to EN 13501-1:2007 +A1:2009 - Fire classification of construction products and building elements.  
\*\*Ask your local sales office for resistance to specific chemicals.

		FIXATIONS	
		ZC (Zinc coated)	SS (Stainless steel)
STANDARD	Wedge anchor	 3/4 in x 5 1/2 in	not available
	Wedge anchor	 Ø18mm (M12) x 130mm	not available
ALTERNATIVES	Concrete screw	 Ø17mm x 130mm	Not available
	Anchor rod (Chemical)	 M16 x 120mm + Chemical resin	not available



**REFERENCE LIST - TB 400 DOUBLE GRILL BARRIER**

SIZE	
Height end posts	maximum 132 in
Height mid post	maximum 132 in
Profile section tubes	Ø8 in (2/5 in thick)
Profile section handrails	2 x 2 3/4 in (1/5 in thick)
Profile section end posts	Outer tube: Ø10 in (2/5 in thick) Inner profile: 4 2/5 x 4 2/5 in (2/5 in thick)
Profile section mid posts	Profile: 4 2/5 x 4 2/5 in (2/5 in thick)
Standard rail length (cc)	50 in (center - center 60 in)
Baseplate	End Post: 10 4/5 x 12 1/2 in (1/2 in thick) Mid Post: 8 5/8 x 11 4/5 in (1/2 in thick)

REQUIREMENTS	
Concrete quality	minimum PSI 4000 (C25/30)
Concrete floor plate thickness	minimum 2/3 in
Concrete slab dimension around posts (in)	31 1/2 (h) x 31 1/2 (w) x 23 5/8 (d)
Operational temperature	14°F up to 104°F
Water and humidity	<b>Steel</b> (standard): dry indoor use only.



### IMPACT LABEL FOR SAFETY BARRIERS

BOPLAN TB 400 DOUBLE GRILL BARRIER		
IMPACT RATING	45°	90°
E80 < 80 kJ		
E60 < 60 kJ	<b>55,3 kJ</b>	
E50 < 50 kJ		
E40 < 40 kJ		<b>39,1 kJ</b>
E35 < 35 kJ		
E30 < 30 kJ		
E25 < 25 kJ		
E20 < 20 kJ		
E15 < 15 kJ		
E10 < 10 kJ		
E5 < 5,0 kJ		
E2 < 2,5 kJ		

**TEST CONDITIONS**

TEMPERATURE: 20°C / 68°F

IMPACT HEIGHT: 650 mm / 25 5/8 Inch

IMPACT ANGLE: 90°

TEST FLOOR: CONCRETE SLAB C25/30 - 160 mm / 6 Inch

MANUFACTURER ANCHOR PULL OUT: 17 kN

**TEST VEHICLE**



WEIGHT: 2300 KG / 5070.63 lbs

TYPE: COMMERCIAL FORK LIFT

SIZE (L x W x h): 1890x1020x1970 mm / 74x40x78 Inch

CONTACT AREA: STEEL BUMPER WIDTH: 600 mm / 24 Inch

**ACCREDITED TEST LABORATORY**



620 Route des Fromentaux  
01500 Saint-Maurice-de-Rémens  
01360 Béligneux  
France

**SUCCESS CRITERIA** VEHICLE STOPPED - ASI (ACCELERATION SEVERITY INDEX) < 0.5

**IL-GD-20230920**

HOLDING POWER		
	Force*	Deflection**
132 in - 9R	F9 = 2800 N	29 1/2 in
121 in - 8R	F8 = 3200 N	28 1/2 in
110 in - 7R	F7 = 3600 N	25 3/4 in
100 in - 6R	F6 = 4100 N	24 5/8 in
90 in - 5R	F5 = 5000 N	20 4/5 in
78 in - 4R	F4 = 6200 N	17 3/4 in
67 in - 3R	F3 = 8400 N	14 1/2 in
56 in - 2R	F2 = 13000 N	10 1/5 in
42 in - 1R	F1 = 21000 N	4 in

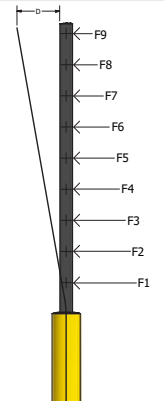

\* Force acting on the center of the hand rails (between posts)  
\*\* Deflection (D) measured on top side.

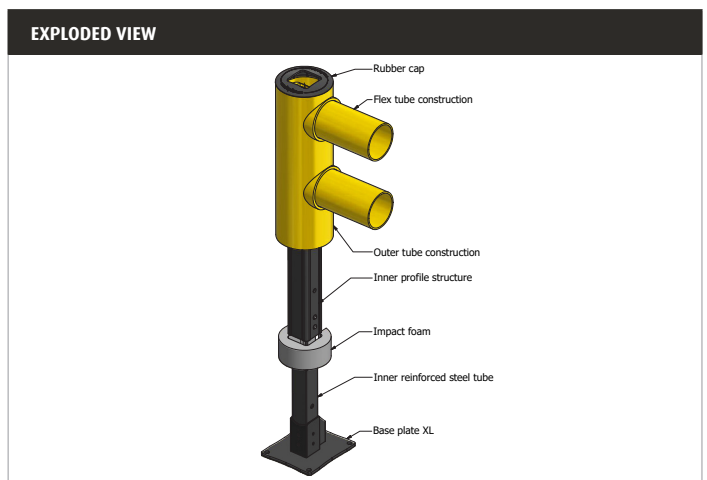

**SPECSHEET >>> 65**

**Boplan USA INC** | 4350 W White Road, Suite 300, Flowery Branch, GA | +1 678 890 5906 | sales@boplan.us | www.boplan.com

DISCLAIMER: ALL PRODUCT SPECIFICATIONS AND DATA ARE SUBJECT TO CHANGE WITHOUT NOTICE TO IMPROVE RELIABILITY, FUNCTION OR DESIGN OR OTHERWISE.  
© Boplan, the Boplan logo, Flex Impact, REXILENE, ICE FLEX, TEDDY PRO and RACKBULL are trademarks of Boplan BV. All other trademarks are property of their respective owners.

**REFERENCE LIST - TB 400 DOUBLE GRILL BARRIER**
**POSTS - 11 in rail distance**

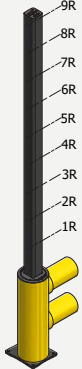
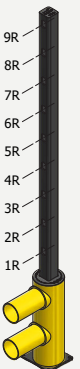
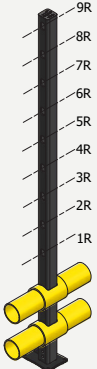
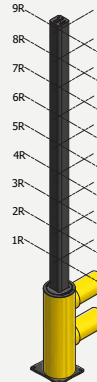
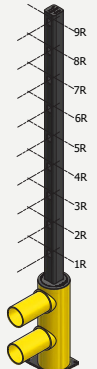
	End post Left	End post Right	Mid post	T-end post - Left (incl. caps)	T-end post - Right (incl. caps)
132 in - 9R	GD4275-3350-EPLYE	GD4275-3350-EPRYE	GD4275-3350-MPYE	GD4275-3350-TPLYE	GD4275-3350-TPRYE
110 in - 7R	GD4275-2800-EPLYE	GD4275-2800-EPRYE	GD4275-2800-MPYE	GD4275-2800-TPLYE	GD4275-2800-TPRYE
					

**RAIL SETS**

	CC36in 26in - YE	CC48in 38in - YE	CC60in 50in - YE	CC72in 62in - YE	CC78in 68in - YE	Conn.tube Ø10 14in - 90° - YE	RUN	STR
9R	GDR900-0665-0915YE	GDR900-0970-1220YE	GDR900-1275-1525YE	GDR900-1579-1829YE	GDR900-1731-1981YE	GDR900-0350-C259YE	GDR900-RUN	GDR900-STR
7R	GDR700-0665-0915YE	GDR700-0970-1220YE	GDR700-1275-1525YE	GDR700-1579-1829YE	GDR700-1731-1981YE	GDR700-0350-C259YE	GDR700-RUN	GDR700-STR

**TECHNICAL DRAWINGS - TB 400 DOUBLE GRILL BARRIER**

Rails 11 in center - center

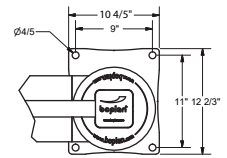
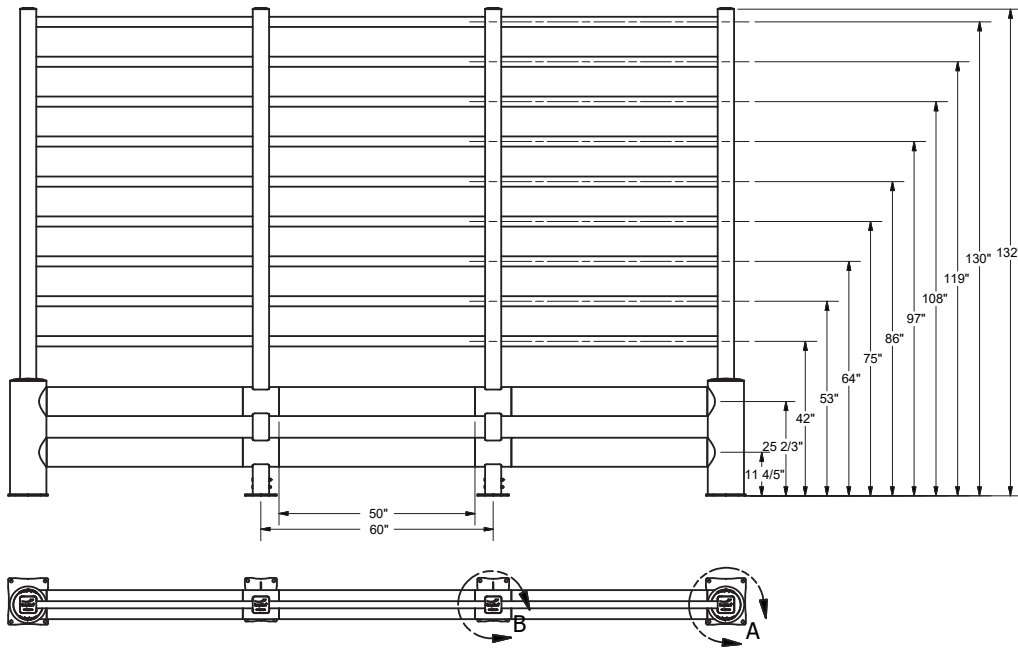

DETAIL A  
SCALE 1 / 8

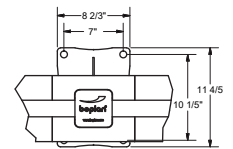

DETAIL B  
SCALE 1 / 8