

# TB 200

## SAFETY BARRIERS

Revision: 9 January 2026 4:12 PM  
Boplan reference: TB200...

### PRODUCT SPECIFICATIONS

APPLICATION			
Environment	The TB 200 is installed low to the ground and therefore serves primarily as a wheel guide or wheel stopper.		
Impact performance at 90°	POST: 9000 Joule (Eq. to 5 ton - 6,8 km/h)		
	RAIL: 21800 Joule (Eq. to 5 ton - 10,6 km/h)		
MATERIAL			
Posts and rails	Extrilene® - UV resistant - Fire class E <sup>+</sup> - Non conductive - Impervious to most chemicals <sup>**</sup>		
Caps	Sustainable elastomer		
STANDARD COLOURS			
End post	Yellow RAL 1003		
Mid post	Yellow RAL 1003		
Impact tube	Yellow RAL 1003		
BASEPLATES			
	Steel	Zinc Coated Steel	Stainless steel
Material	Steel 37	Steel 37	Stainless steel 304
Coating	Laquered	Electroplated + Laquered	No coating
Colour	High gloss black	Mat black	Natural colour

\*Classification according to EN 13501-1:2007 +A1:2009 - Fire classification of construction products and building elements.

\*\*Ask your local sales office for resistance to specific chemicals.

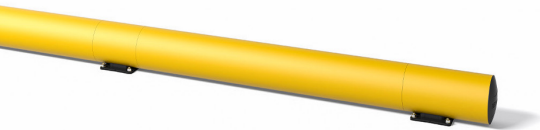

FIXATIONS				
			ZC (Zinc coated)	SS (Stainless steel)
STANDARD	Wedge anchor		M12 x 120 mm	M12 x 120 mm
	Anchor rod (Chemical)		M12 x 120 mm + Chemical resin	M12 x 120 mm + Chemical resin
ALTERNATIVES	Asphalt anchor		Bolt M10 x 40 mm + Screw Ø16 mm	Not available
	Spit anchor		Bolt M12 x 100 mm + Plug Ø20 mm	Not available

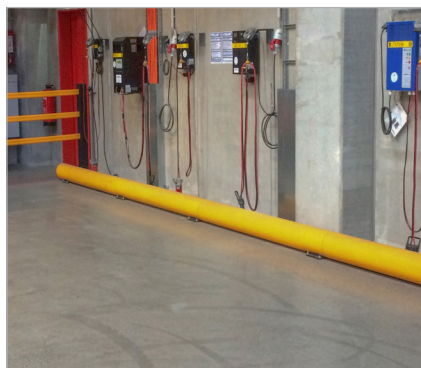

**FEATURES AND FUNCTIONALITY - TB 200**

SIZE	
Height end posts	210 mm
Height mid post	210 mm
Profile section tubes	Ø200 mm (11 mm thick)
Profile section end posts	Outer tube: Ø200 mm (11 mm thick) Inner profile: 112 mm x 112 mm (10 mm thick)
Profile section mid posts	Profile: 112 mm x 112 mm (10 mm thick)
Standard rail length	1350 mm (other sizes: 750 mm - 1750 mm)
Baseplate	End Post: 180 mm x 180 mm (10 mm thick) Mid Post: 180 mm x 180 mm (10 mm thick)

REQUIREMENTS	
Concrete quality	minimum C25/30
Concrete floor plate thickness	minimum 150 mm
Concrete slab dimension around posts (mm)	600 (h) x 600 (w) x 500 (d)
Operational temperature	-10°C up to +40°C
Water and humidity	<b>Steel (standard):</b> dry indoor use only. <b>Zinc coated:</b> outdoor use in most environments. <b>Stainless steel:</b> outdoor use or frequent exposure to water and humidity.

**boplan** **IMPACT LABEL FOR SAFETY BARRIERS**

**BOPLAN TB 200**

IMPACT RATING	45°	90°
E80 < 80 kJ		
E60 < 60 kJ		
E50 < 50 kJ		
E40 < 40 kJ		
E35 < 35 kJ	<b>30,8 kJ</b>	
E30 < 30 kJ		
E25 < 25 kJ		<b>21,8 kJ</b>
E20 < 20 kJ		
E15 < 15 kJ		
E10 < 10 kJ		
E5 < 5,0 kJ		
E2 < 2,5 kJ		

**TEST CONDITIONS**

TEMPERATURE: 20°C / 68°F  
IMPACT HEIGHT: 110 mm / 4.3 in  
IMPACT ANGLE: 90°  
TEST FLOOR: CONCRETE C25/30 - 160 mm / 6.3 in  
MANUFACTURER ANCHOR PULL OUT: 7,9 kN

**TEST VEHICLE**

WEIGHT: 2300 KG / 5070 lbs  
TYPE: COMMERCIAL FORK LIFT  
SIZE (L x W x h): 1890 x 1020 x 1970 mm  
SIZE (L x W x h): 74.4 x 40.2 x 77.5 in  
CONTACT AREA: STEEL BUMPER WIDTH: 600 mm / 23.6 in

**ACCREDITED TEST LABORATORY**

**tno**  
620 Route des Fromentaux  
01500 Saint-Maurice-de-Rémens  
01360 Beligneux  
France

**SUCCESS CRITERIA** VEHICLE STOPPED - ASI (ACCELERATION SEVERITY INDEX) < 0.5

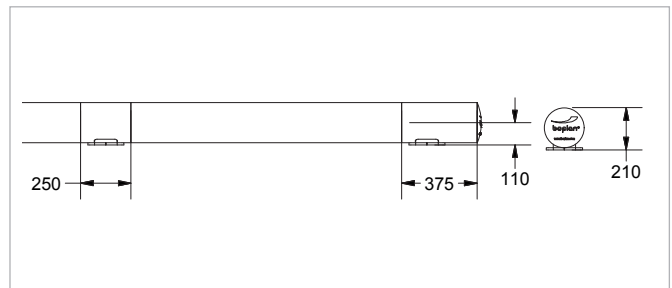
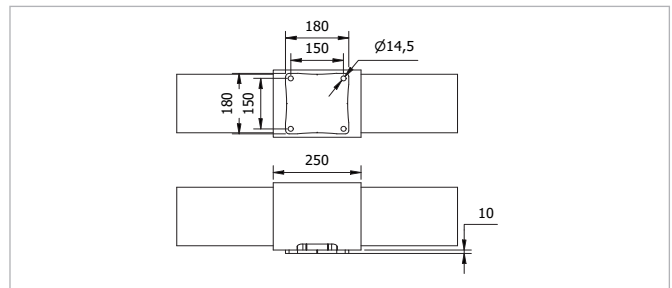
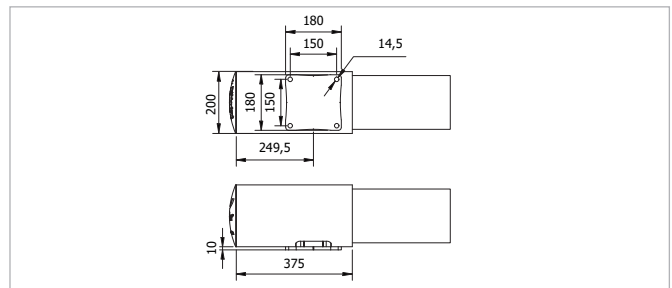

**REFERENCE LIST - TB 200**

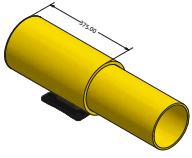
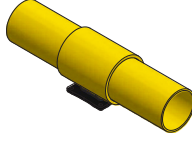
POSTS		
End post End post - Zinc coated End post - Stainless steel	TB2000-0001-EPYE TB2000-0001-EPYEZ TB2000-0001-EPYES	
Mid post Mid post - Zinc coated Mid post - Stainless steel	TB2000-0001-MPYE TB2000-0001-MPYEZ TB2000-0001-MPYES	

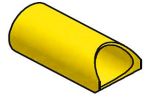
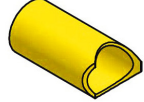
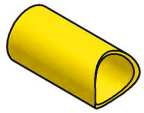
CURVES		
Conn.tube Ø200 Curve 350 mm - YE	TB2000-0350-C200YE	
Conn.tube Ø200 - 90° Curve 350 mm - YE	TB2000-0350-C209YE	
Conn.tube Ø250 Curve 350 mm - YE	TB2000-0350-C250YE	

RAIL SETS			
	Tube length (A)	CC length (B)	Reference
Standard rail	750 mm	1000 mm	TB2000-0750-1000YE
Standard rail	950 mm	1200 mm	TB2000-0950-1200YE
Standard rail	1150 mm	1400 mm	TB2000-1150-1400YE
Standard rail	1350 mm	1600 mm	TB2000-1350-1600YE
Standard rail	1550 mm	1800 mm*	TB2000-1550-1800YE
Standard rail	1750 mm	2000 mm*	TB2000-1750-2000YE
Short rail	600-1349 mm	850-1599 mm	TB2009-1599-SRYE
Long rail	1351-1749 mm	1601-2000 mm*	TB2009-2000-LRYE

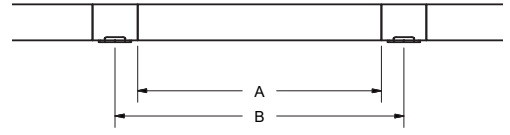

\* The impact performance has not been tested for tube lengths > 1600 mm. Only use these lengths for non-critical applications.

**REFERENCE LIST - TB 200**

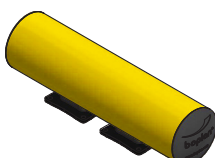
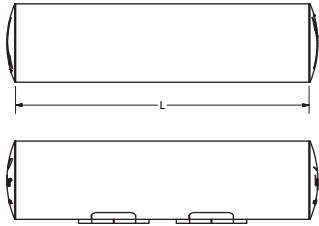
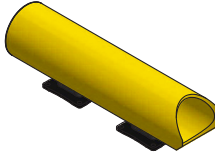
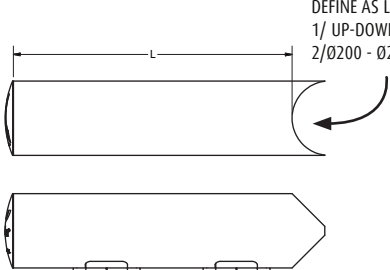
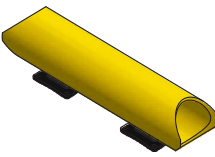
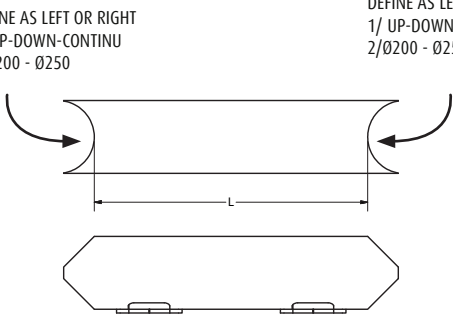
FIXED UNITS					
TYPE	LENGTH	BASE	REFERENCE YE		
no curves	750 mm	Steel ZC SS	TB2000-0750-FUYE TB2000-0750-FUYEZ TB2000-0750-FUYES		
	751-1750 mm	Steel ZC SS	TB2001-1750-FUYE TB2001-1750-FUYEZ TB2001-1750-FUYES		
1 curve	750 mm	Steel ZC SS	TB2000-0750-FU1CYE TB2000-0750-FU1CYEZ TB2000-0750-FU1CYES		 <p>DEFINE AS LEFT OR RIGHT 1/ UP-DOWN-CONTINU 2/Ø200 - Ø250</p>
	751-1750 mm	Steel ZC SS	TB2001-1750-FU1CYE TB2001-1750-FU1CYEZ TB2001-1750-FU1CYES		
2 curves	750 mm	Steel ZC SS	TB2000-0750-FU2CYE TB2000-0750-FU2CYEZ TB2000-0750-FU2CYES		 <p>DEFINE AS LEFT OR RIGHT 1/ UP-DOWN-CONTINU 2/Ø200 - Ø250</p> <p>DEFINE AS LEFT OR RIGHT 1/ UP-DOWN-CONTINU 2/Ø200 - Ø250</p>
	751-1750 mm	Steel ZC SS	TB2001-1750-FU2CYE TB2001-1750-FU2CYEZ TB2001-1750-FU2CYES		