

RE RACK END

RACK PROTECTION

Revision: 12 January 2026 2:00 PM
Boplan reference: RE200...

PRODUCT SPECIFICATIONS

APPLICATION

Environment	The RE Rack End is the optimal protection for your rack ends, with the two bollards offering optimal protection to your corner uprights. Driving over the chamfered fixations does not damage them.
Impact performance at 90°	END POST: 3000 Joule (Eq. to 2,5 ton - 5,5 km/h)
	RAIL: 8500 Joule (Eq. to 2,5 ton - 9,3 km/h)

MATERIAL

RE Rack end	Extrilene® - UV resistant - Fire class E ⁺ - Non conductive - Impervious to most chemicals ^{**}
-------------	---

STANDARD COLOURS



Rails	Yellow RAL 1003
Posts	Yellow RAL 1003

BASEPLATES

	Steel (CHF)	Zinc Coated Steel (CHF)	Stainless steel (CHF)
Material	Steel 37	Steel 37	Stainless steel 304
Coating	Lacquered	Electroplated + Laquered	No lacquer / No coating
Colour	High gloss black	Mat black	Natural colour

*Classification according to EN 13501-1:2007 +A1:2009 - Fire classification of construction products and building elements.
**Ask your local sales office for resistance to specific chemicals.

FIXATIONS

		ZC (Zinc coated)	SS (Stainless steel)
STANDARD	Wedge anchor		
	Countersunk		
		Ø12mm (M8) x 90mm	Ø12mm (M8) x 85mm

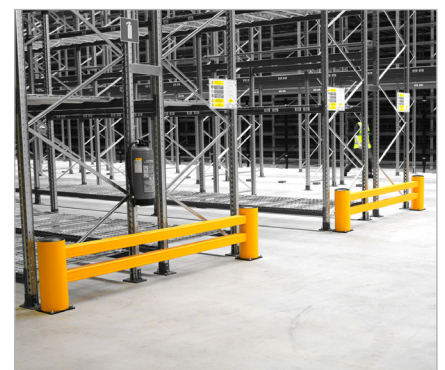

FEATURES AND FUNCTIONALITY - RACK END

SIZE	
Height end/mid posts	530 mm
Height rail support post	510 mm
Profile section rails	88 mm x 88 mm (7.5mm thick)
Profile section end/mid posts	Outer tube: Ø200 mm (11 mm thick) Inner profile: 112 mm x 112 mm (10 mm thick)
Profile section support post	Profile: 112 mm x 112 mm (10 mm thick)
Standard rail length	2200 mm (variable: 750mm - 3200mm)
Baseplates	End Post: 210 mm x 210 mm (10 mm thick) Mid Post: 180 mm x 180 mm (10 mm thick)

REQUIREMENTS	
Concrete quality	minimum C25/30
Concrete floor plate thickness (mm)	minimum 150 mm
Concrete slab dimension around posts (mm)	500 (h) x 500 (w) x 400 (d)
Rack ends longer than 2500 mm	Add a rail support post
Operational temperature	-10°C up to +40°C
Water and humidity	Steel (standard): dry indoor use only. Zinc coated: outdoor use in most environments. Stainless Steel: outdoor use or frequent exposure to water and humidity.

boplan **IMPACT LABEL FOR SAFETY BARRIERS**

BOPLAN RE RACK END		
IMPACT RATING	45°	90°
E80 > 80 kJ		
E60 > 60 kJ		
E50 > 50 kJ		
E40 > 40 kJ		
E35 > 35 kJ		
E30 > 30 kJ		
E25 > 25 kJ		
E20 > 20 kJ		
E15 > 15 kJ	12,0 kJ	
E10 > 10 kJ		8,5 kJ
E5 > 5,0 kJ		
E2 > 2,5 kJ		

TEST CONDITIONS TEMPERATURE: 20°C / 68°F IMPACT HEIGHT: 420 mm / 16.5 Inch IMPACT ANGLE: 90° TEST FLOOR: CONCRETE C25/30 - 160 mm / 6 Inch MANUFACTURER ANCHOR PULL OUT: 13 kN	TEST VEHICLE WEIGHT: 2300 KG / 5070.63 lbs TYPE: COMMERCIAL FORK LIFT SIZE (L x W x H): 1890x1020x1970 mm / 74x40x78 Inch CONTACT AREA: STEEL BUMPER WIDTH: 600 mm / 24 Inch	BOPLAN TEST CENTRE Muizelstraat 12 8560 Moorsele Belgium
--	---	--

SUCCESS CRITERIA VEHICLE STOPPED - ASI (ACCELERATION SEVERITY INDEX) < 0.5

REFERENCE LIST - RACK END
RACK END POST BO 200

 End post
 End post - ZC
 End post - SS

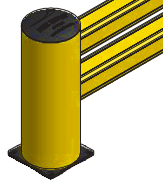
 RE2009-0001-EPYE
 RE2009-0001-EPYEZ
 RE2009-0001-EPYES

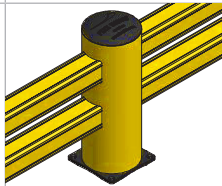
 Mid post
 Mid post - ZC
 Mid post - SS

 RE2009-0001-MPYE
 RE2009-0001-MPYEZ
 RE2009-0001-MPYES

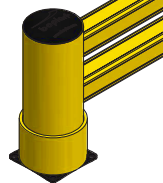
RACK END ROTOR POST BO 200

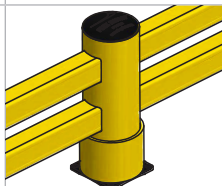
 End post
 End post - ZC
 End post - SS

 RE2009-0001-EPRYE
 RE2009-0001-EPRYEZ
 RE2009-0001-EPRYES

 Mid post
 Mid post - ZC
 Mid post - SS

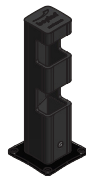
 RE2009-0001-MPRYE
 RE2009-0001-MPRYEZ
 RE2009-0001-MPRYES

RACK END RAIL SUPPORT POST

 Rail support post
 Rail support post - ZC
 Rail support post - SS

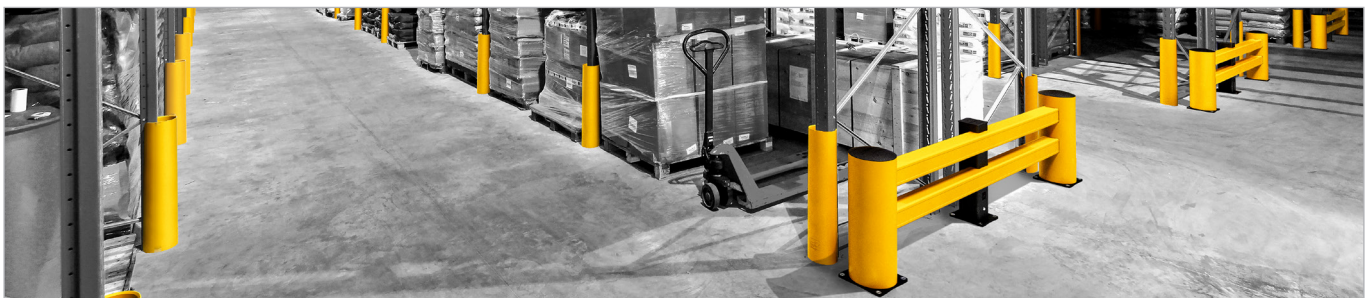
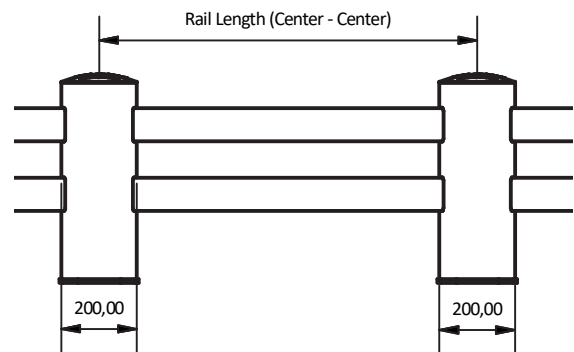
 RE2009-0001-SPBL
 RE2009-0001-SPBLZ
 RE2009-0001-SPBLS

RAIL SETS

	Rail length	Reference
Rail set (2pcs) - YE	750mm - 1350mm	RE2009-1350-S200YE
Rail set (2pcs) - YE	1351mm - 1800mm	RE2009-1800-S200YE
Rail set (2pcs) - YE	1801mm - 2500mm	RE2009-2500-S200YE

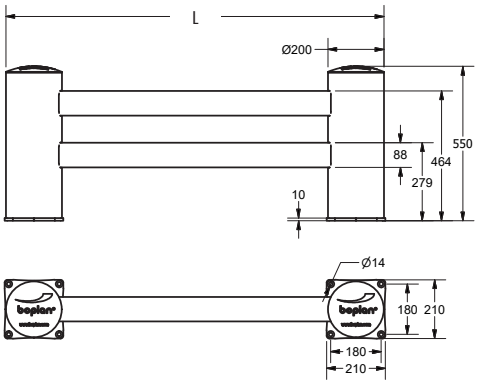
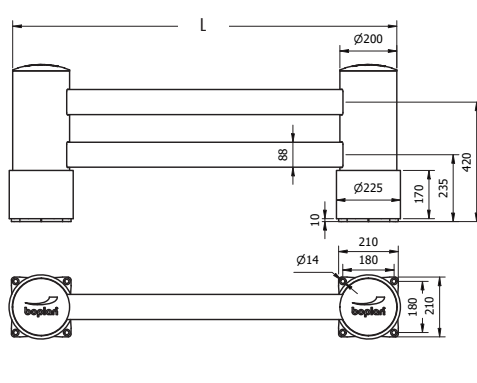

REFERENCE LIST - RACK END

TOTAL LENGTH (L)	BASEPLATE	RACK END BOLLARD (YELLOW)	RACK END BOLLARD WITH ROTOR (YELLOW)
1100mm	steel ZC SS	RE2000-1100-0001YE RE2000-1100-0001YEZ RE2000-1100-0001YES	RE2000-1100-R001YE RE2000-1100-R001YEZ RE2000-1100-R001YES
1200 mm	steel	RE2000-1200-0001YE	
2200mm	steel ZC SS	RE2000-2200-0001YE RE2000-2200-0001YEZ RE2000-2200-0001YES	RE2000-2200-R001YE RE2000-2200-R001YEZ RE2000-2200-R001YES
2400mm	steel ZC SS	RE2000-2400-0001YE RE2000-2400-0001YEZ RE2000-2400-0001YES	RE2000-2400-R001YE RE2000-2400-R001YEZ RE2000-2400-R001YES
2500 mm	steel	RE2000-2500-0001YE	
750mm - 1350mm	steel ZC SS	RE2001-1350-0001YE RE2001-1350-0001YEZ RE2001-1350-0001YES	RE2001-1350-R001YE RE2001-1350-R001YEZ RE2001-1350-R001YES
1351mm - 1800mm	steel ZC SS	RE2001-1800-0001YE RE2001-1800-0001YEZ RE2001-1800-0001YES	RE2001-1800-R001YE RE2001-1800-R001YEZ RE2001-1800-R001YES
1801mm - 2500mm	steel ZC SS	RE2001-2500-0001YE RE2001-2500-0001YEZ RE2001-2500-0001YES	RE2001-2500-R001YE RE2001-2500-R001YEZ RE2001-2500-R001YES
			
LENGTH	BASEPLATE	RACK END BOLLARD (YELLOW)	RACK END BOLLARD WITH ROTOR (YELLOW)
2501mm - 3200mm INCLUDING RAIL SUPPORT	steel ZC SS	RE2001-3200-0001YE RE2001-3200-0001YEZ RE2001-3200-0001YES	RE2001-3200-R001YE RE2001-3200-R001YEZ RE2001-3200-R001YES
		