

BO SLEEVE

PRODUCT SPECIFICATIONS

ACCESSORIES

Revision: 27 January 2026 8:42 AM
Boplan reference: BS...

APPLICATION	
Environment	Polymer sleeve that can be slid over existing bollards.
MATERIAL	
Tube	Extrilene® - UV resistant - Fire class E® - Non conductive - Impervious to most chemicals**
COLOURS	
Sleeve	Standard: Yellow RAL 1003 Also available in Black RAL 9005 (Multicolour)
BASEPLATES	
No baseplate	
FIXATIONS	
No fixations	

*Classification according to EN 13501-1:2007 +A1:2009 - Fire classification of construction products and building elements.
**Ask your local sales office for resistance to specific chemicals.



REFERENCE LIST - BO SLEEVE

Sleeve 125x105

Advised application diameter **90 mm - 100 mm**

H: 500-1000 mm
YELLOW BS1251-1000-0001YE

H: 500-1000 mm
Multicolour (BL) BS1251-1000-0001MC

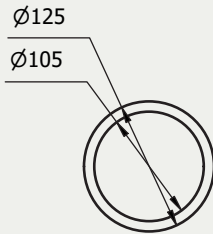

Sleeve 200x178

Advised application diameter **165 mm - 175 mm**

H: 500-1200 mm
YELLOW BS2001-1200-0001YE

H: 500-1200 mm
Multicolour (BL) BS2001-1200-0001MC

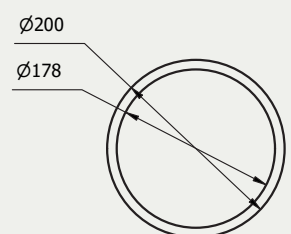

Sleeve 225x204

Advised application diameter **200 mm** (Perfect fit for Boplan B0200R and B0200F)

H: 160-400 mm
YELLOW BS2251-0400-0001YE

H: 500-1200 mm
YELLOW BS2251-1200-0001YE

H: 170 mm
YELLOW BS2250-0170-0001YE

H: 400 mm
YELLOW BS2250-0400-0001YE

H: 555 mm
YELLOW BS2250-0555-0001YE

H: 555 mm
Multicolour (BL) BS2250-0555-0001MC

H: 805 mm
YELLOW BS2250-0805-0001YE

H: 805 mm
Multicolour (BL) BS2250-0805-0001MC

H: 1005 mm
YELLOW BS2250-1005-0001YE

H: 1005 mm
Multicolour (BL) BS2250-1005-0001MC

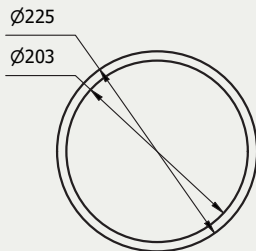

Sleeve 250x228

Advised application diameter **215 mm - 225 mm**

H: 500-1200 mm
YELLOW BS2501-1200-0001YE

H: 500-1200 mm
Multicolour (BL) BS2501-1200-0001MC

